

PRODIGY

RGY3 SERIES INSTALLATION GUIDE

STEP 1 - ADJUST AND SECURE HOUSING TO CEILING FRAME

Loosen secure screws to extend hanger bars to appropriate distance and collar center position, lock or fix on ceiling frame depends on the ceiling types.

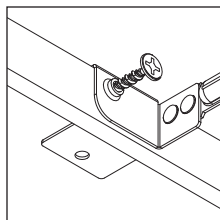
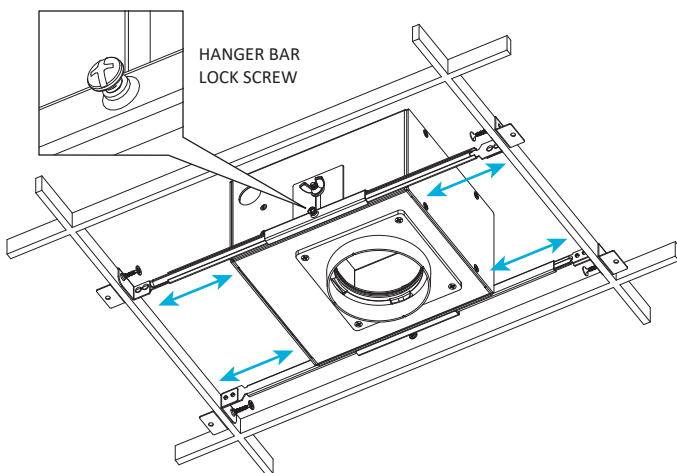

T-BAR

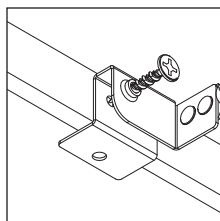

WOOD

STEP 2 - ADJUST HOUSING HEIGHT

Loosen wing nuts on both side of housing to adjust housing height if necessary.

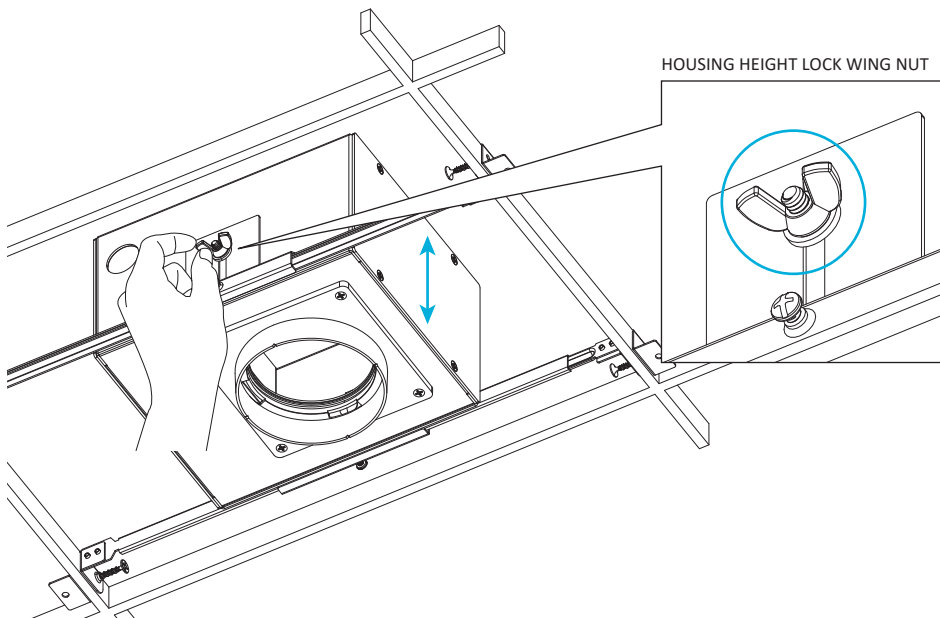

STEP 2 - SQUARE COLLAR ADJUSTMENT (OPTIONAL)

Sqaure collar can be rotated $\pm 3.5^\circ$ for parallel alignment by lossen collar lock screws if necessary.

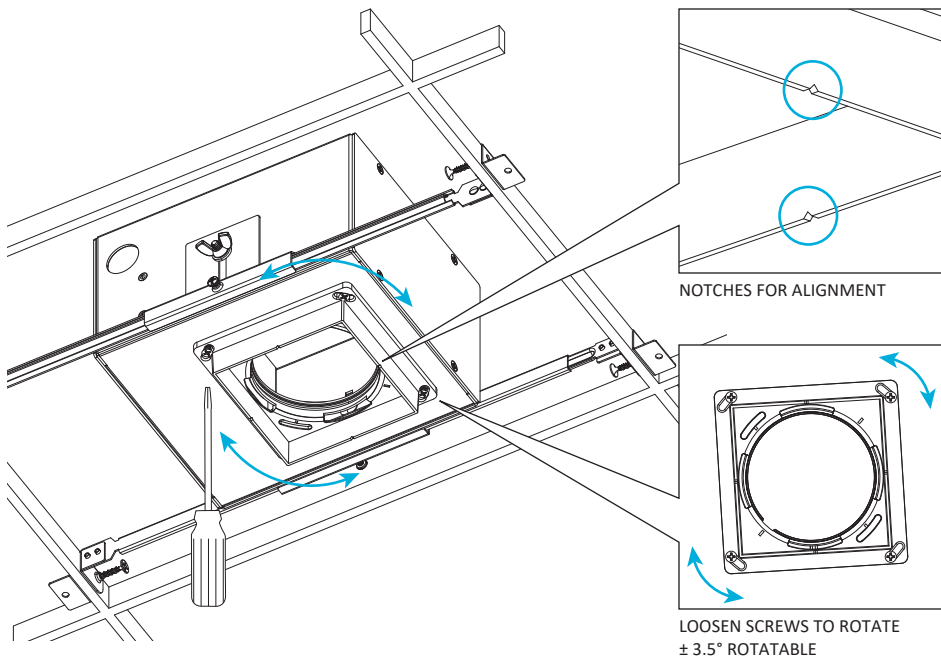

STEP 4 - CUT OUT AND INSTALL CEILING

Cut appropriate aperture shape and size refer to size below and install ceiling.

ROUND CUT-OUT SIZE
 $\varnothing 3-5/8"$ ($\varnothing 93$ mm)

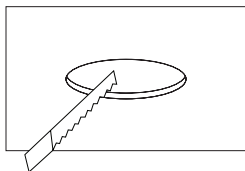

SQUARE CUT-OUT SIZE
3-5/8" x 3-5/8" (93 x 93mm)

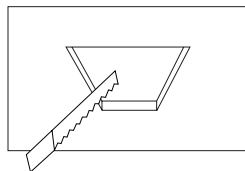

For trimless type, attach mud ring to ceiling with screws and cover with a thin layer finish plaster.

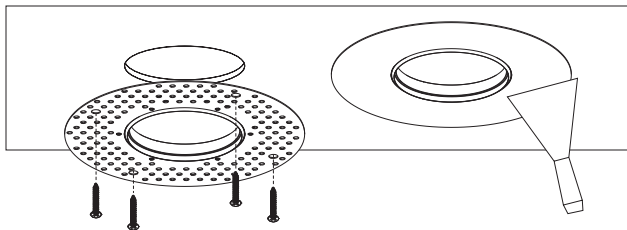

STEP 5 - MAKE ELECTRICAL CONNECTION

Follow the steps to connect supply wires.

STEP 5-1

Loosen junction box cover screws.

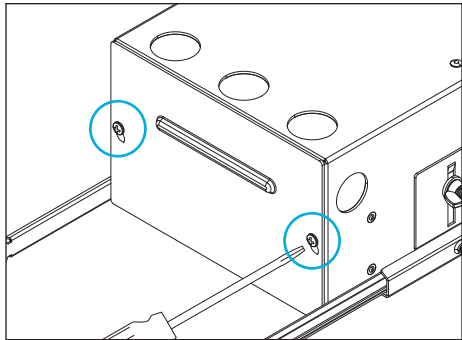

STEP 5-2

Push out junction box cover.

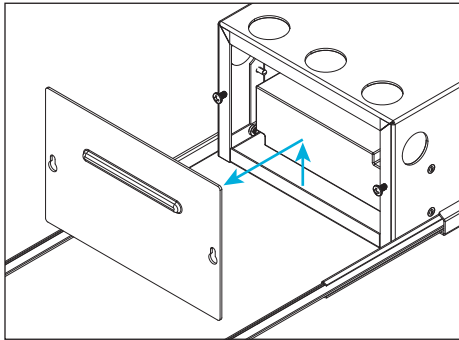

STEP 5-3

Remove knock-out(s) where needed with screwdriver.

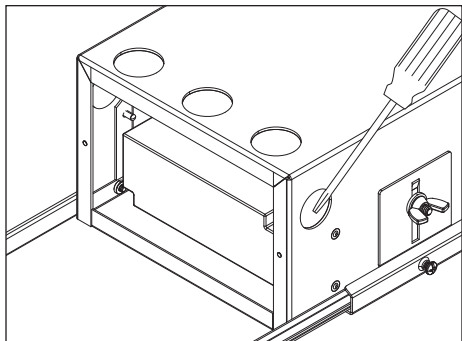

STEP 5-4

Pass through supply wires and connect with wire nuts.

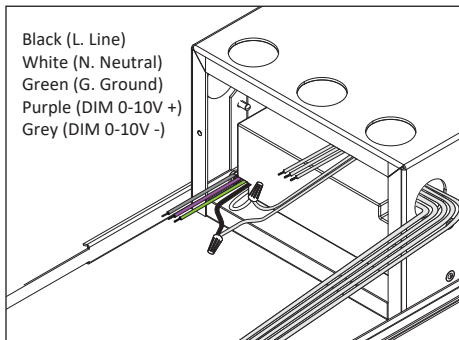

STEP 5-5

Reattach and lock junction box cover.

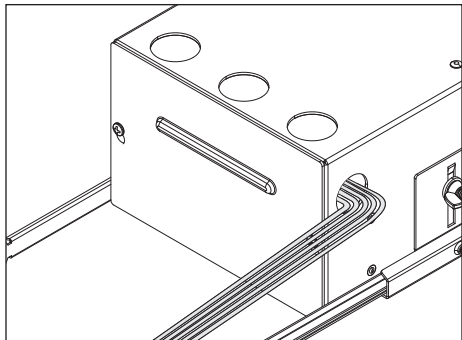

STEP 6 - MODULE COMBINATION

Select components according to requirement.

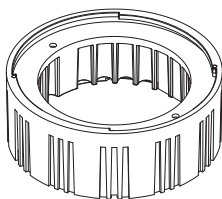

FIXED MODULE HOLDER

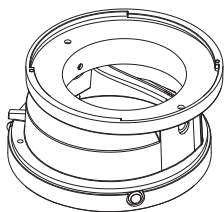

ADJUSTABLE MODULE HOLDER

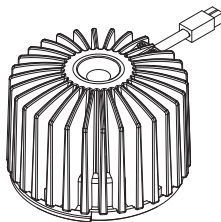

LED MODULE & HEATSINK

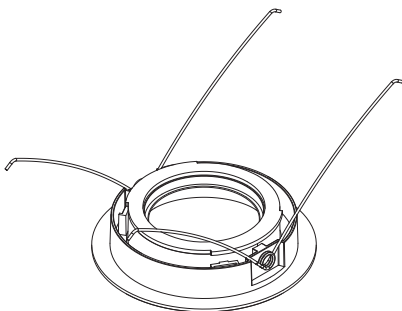

FLANGED TRIM

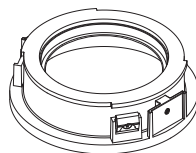

FLANGELESS TRIM

STEP 7 - ASSEMBLE AND INSTALL FIX MODULE

For adjustable module, refer to Step 8.

STEP 7-1

Add desired media to optic media holder, align notches and snap onto optic lens.

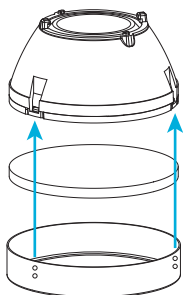

Ø50 mm FIX MODULE
OPTIC LENS

MEDIA MAX
THICKNESS: 3 mm

MEDIA HOLDER COMES
WITH OPTIC LENS

STEP 7-2

Align optic lens to LED module notches and twist clockwise to install it onto module.

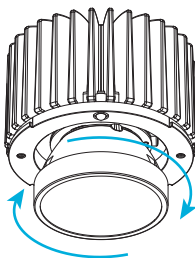
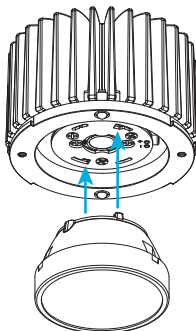

STEP 7-3

Align notch indicators on holder and trim, and push-twist clockwise to secure together.

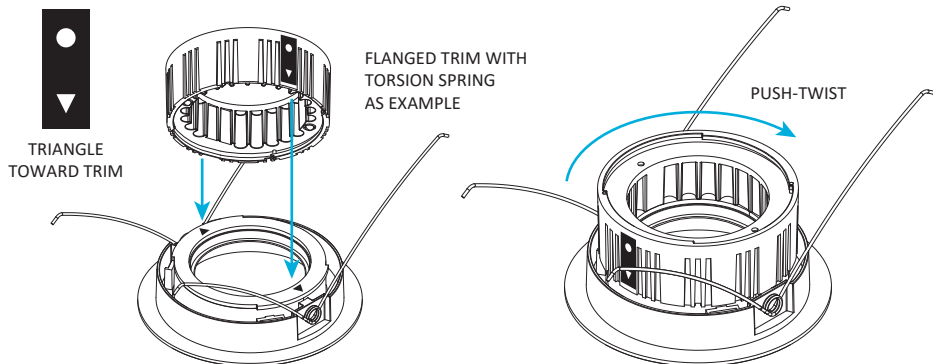

STEP 7-4

Align notches on LED module and holder, and push-twist clockwise to secure together.

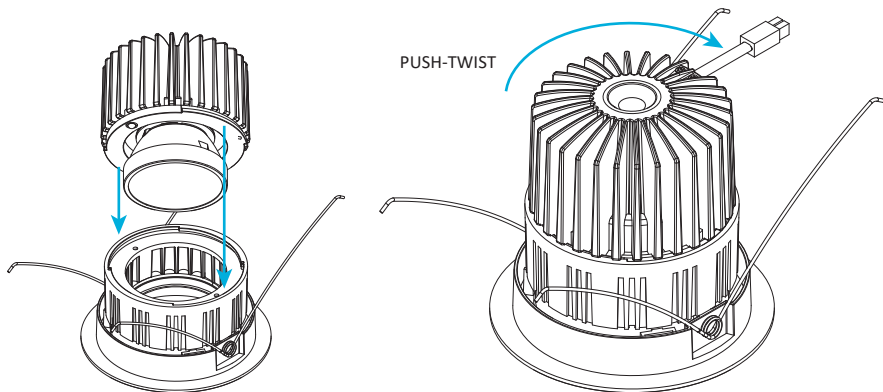

STEP 7-5

Connect assembled module to driver wire.

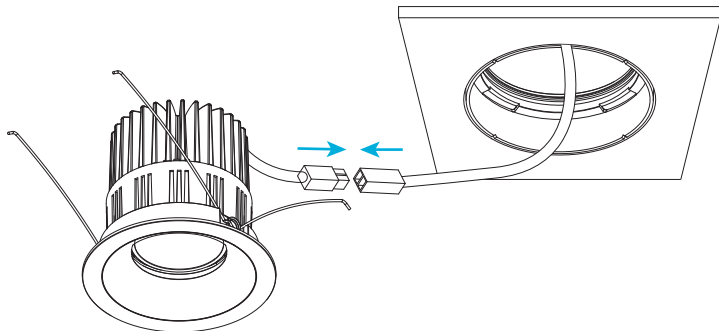

RGY3 SERIES INSTALLATION GUIDE

STEP 7-6 - INSTALL MODULE INTO HOUSING

INSTALL FLANGED MODULE

Compress springs and insert module into housing.

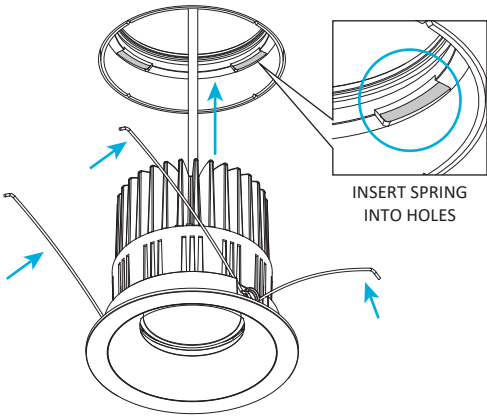

FLANGED MODULE
INSTALLATION FINISHED

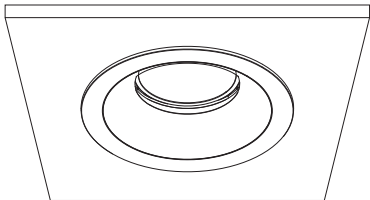

INSTALL FLANGELESS MODULE)

Insert module direct into housing.

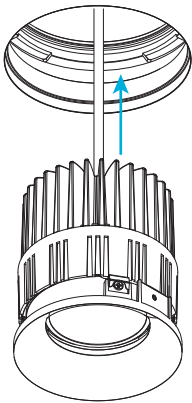

FLANGELESS MODULE
INSTALLATION FINISHED

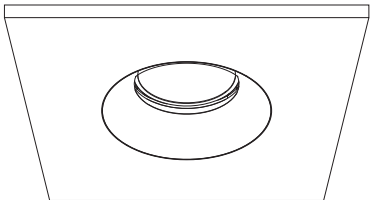

STEP 8 - ASSEMBLE AND INSTALL ADJUSTABLE MODULE

For fix module, refer to Step 7.

STEP 8-1

Add desired media to optic media holder, align notches and snap onto optic lens.

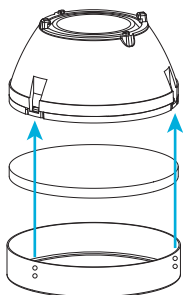

Ø45 mm ADJUSTABLE
MODULE OPTIC LENS

MEDIA MAX
THICKNESS: 3 mm

MEDIA HOLDER COMES
WITH OPTIC LENS

STEP 8-2

Align optic lens to LED module notches and twist clockwise to install it onto module.

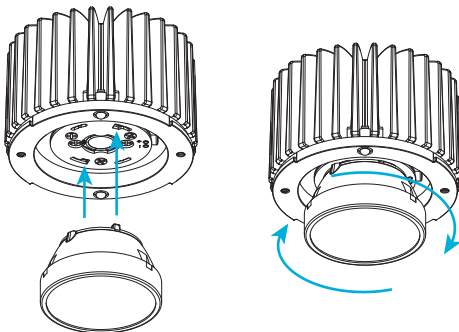

STEP 8-3

Align notches on LED module and holder, and push-twist clockwise to secure together.

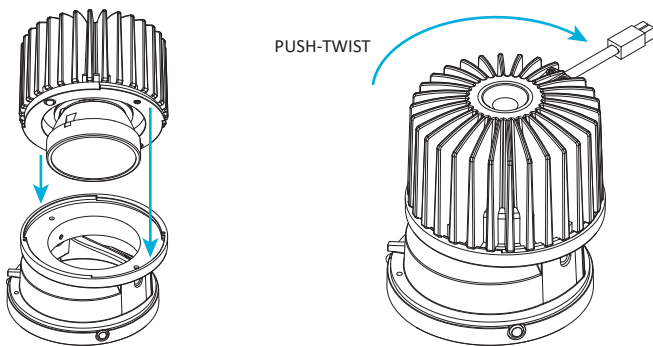

STEP 8-4

Connect assembled module to driver wire.

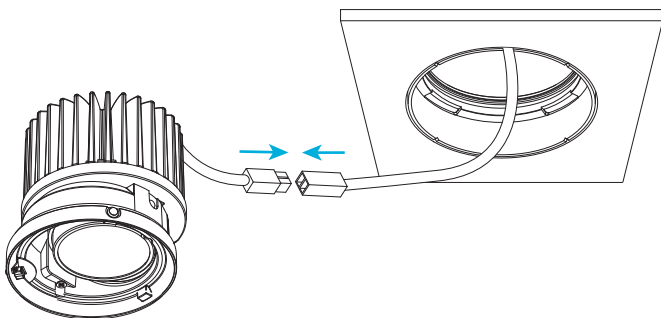

RGY3 SERIES INSTALLATION GUIDE

STEP 8-5

Align tip on module to indicator on collar to insert it into housing.

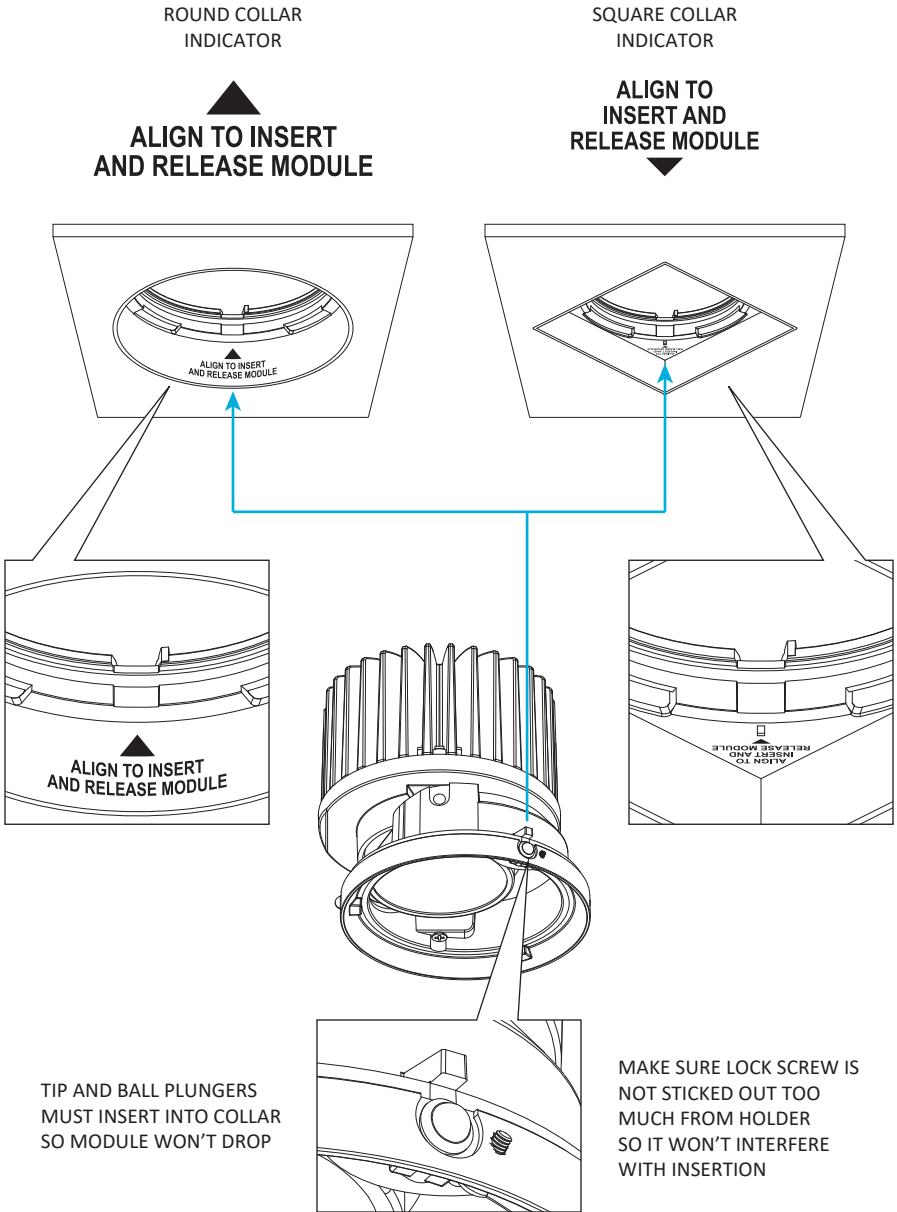

RGY3 SERIES INSTALLATION GUIDE

STEP 8-6 TILT MODULE (OPTIONAL)

Loosen screws and use finger to adjust beam tilt angle for Open / Parabolic trim if necessary, max 35° tiltable. For Pinhole / Wallwash trim, keep tilt angle 0°.

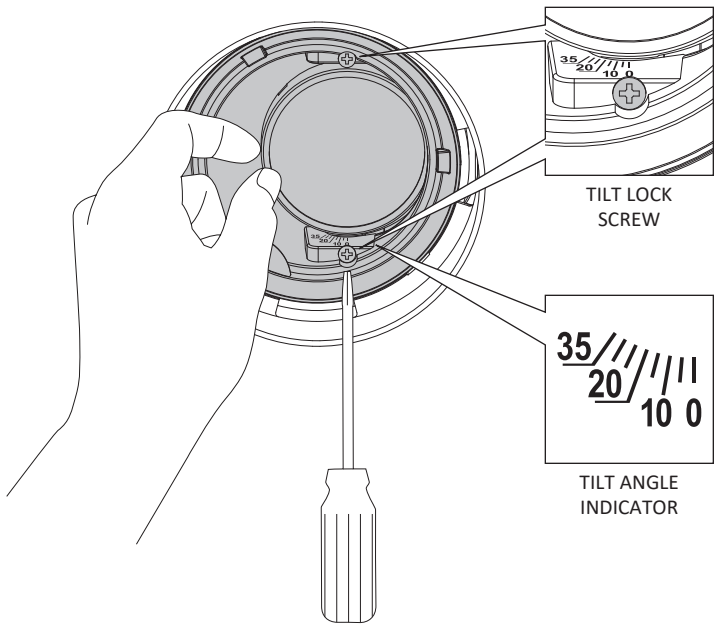

EXAMPLE: TITLED 0°

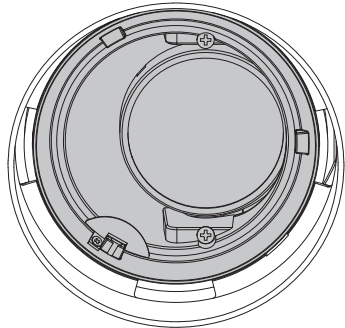

EXAMPLE: TITLED 35°

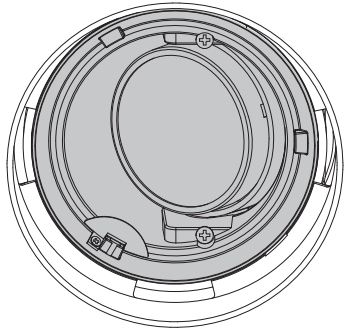

RGY3 SERIES INSTALLATION GUIDE

STEP 8-7 ROTATE MODULE (OPTIONAL)

Loosen screw and use finger to rotate module if necessary, 360° rotatable both direction.

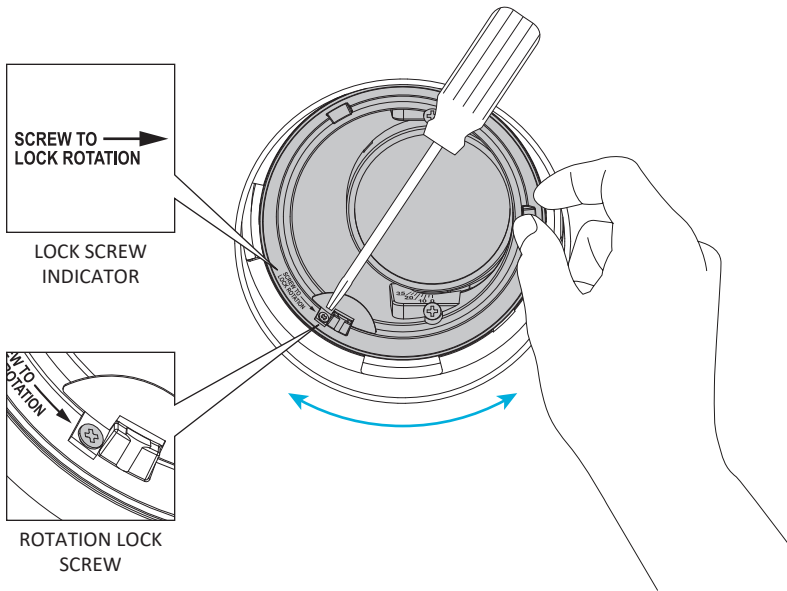

EXAMPLE: ROTATED WITH TITLED 0°

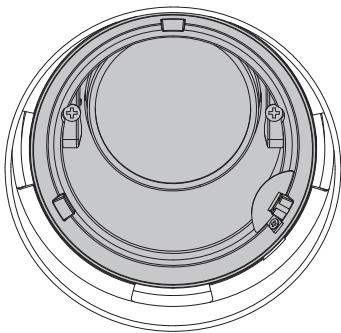

EXAMPLE: ROTATED WITH TITLED 35°

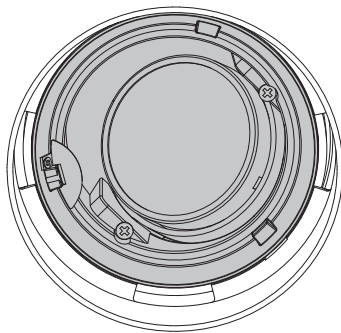

STEP 8-8 INSTALL TRIM

INSTALL FLANGED TRIM

Compress springs and insert trim into housing.

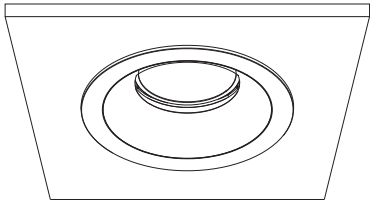
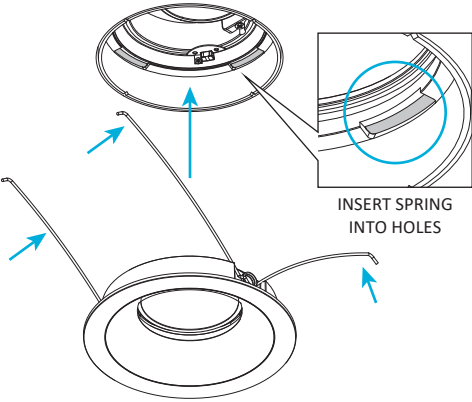

INSTALL FLANGELESS TRIM

Insert trim direct into housing.

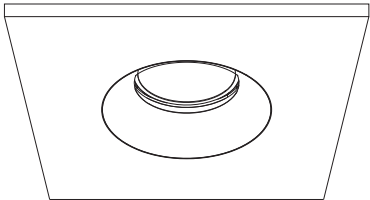
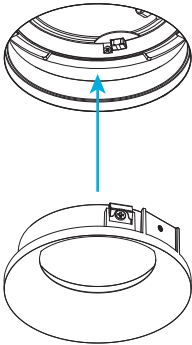

INSTALL ROUND WALLWASH TRIM

Insert into housing depends on trim style and rotate wallwash opening to wall.

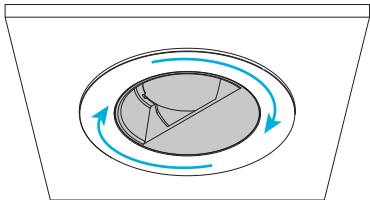

INSTALL SQUARE WALLWASH TRIM

Point wallwash opening toward wall and insert into housing depends on trim style.

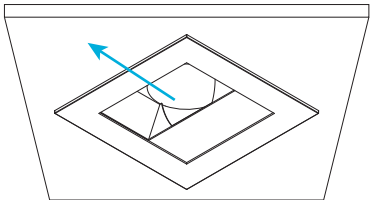

integer
Lights