

## 3" LED ARCHITECTURAL SQUARE FLANGELESS DOWNLIGHT

### NEW CONSTRUCTION: IC & NON IC



## GENERAL INFORMATION

### USE OF PRODUCT

The 3" Prime Downlight is a small aperture fixture with a shallow housing height of 4 3/4", which is ideal for residential and commercial applications. Available options include die-cast or spun aluminum trims, various color temperatures, optics, filters, and dimmable drivers.

### LED ENGINE

LED engine available in 2700K, 3000K, 3500K, or 4000K in standard 90+ CRI. 2-step MacAdam ellipse allows for color consistency between fixtures. The LED is mounted to an aluminum heat sink for maximum life output and thermal management. LED engine is accessible from below the ceiling.

### OPTICAL LENS

Field replaceable optical lenses are available in 12°, 25°, 30°, 40°, 50°, and 70°. Easily achieve narrow spot to wide flood beam pattern.

### FRAME CONSTRUCTION

IC and Non-IC rated housing are constructed from a 16-gauge heavy-duty, powder-coated cold-rolled steel frame and includes a junction box with 1/2" knockouts. Butterfly brackets (included) accommodate universal or C-channel hangers (order separately).

### ADJUSTMENT

- Housing supports 359° locking rotation.
- Aperture collar compatible up to 1 1/2" ceiling thickness. Consult factory for made-to-order aperture collars exceeding 1 1/2".

### DIMMING

Available in nine driver selections. (ID) Standard all-inclusive ELV (120V), Triac (120V), and 0-10V (120-277V) dimming driver called Intelligent Drive, (EEI) eldoLED 1% Dim 0-10V, (EES) eldoLED 1% Dim 0-10V (120-277V) and Triac (120V), Max 20W, (EDIO) eldoLED 0.1 Dim 0-10V, (EDID) eldoLED 0.1% Dim DALI, (EDD) eldoLED 1% Dim DALI2, (LDE1) Lutron Hi-Lume 1% Ecosystem with Soft-on, Fade-to-Black Dimming, (L3DA) Hi-Lume 1% Ecosystem/3-Wire L3D Driver, (PEQ0) Lutron Hi-Lume Premier Ecosystem 0.1% with Soft-on, Fade-to-Black Dimming.

### BEVEL

Bevel includes standard frosted acrylic diffuser. Remove standard frosted acrylic diffuser in field for 7% lumens increase. Consult factory for made-to-order finishes. Wet location for bathrooms and showers with standard lens on trim.

### EMERGENCY BATTERY

Optional Emergency Battery (EM) available in 4W (≈400 lm), 8W (≈800 lm), or 15W (≈1,500 lm) available for a minimum of 90 minutes. Please review page 8 for integral or remote EM and test switch options with solutions that allow for EM replacement from below the ceiling.

### LABELS/COMPLIANCE/WARRANTY

- CSA listed for US and Canada
- Energy Star certified product
- Dry/Damp/Wet location rated
- State of California Title 24 and JA8 compliant
- Chicago Plenum with IC Housing
- 5-year limited warranty



## GENERAL PERFORMANCE CHART

\*Detailed performance chart may be found on page 3

	6W	9W	12W	15W	20W	24W	28W	32W
<b>Initial Lumens</b>	657/955	890/1296	1122/1618	1267/2015	1485/2422	2799	3128	3405
<b>Delivered Lumens</b>	586-755	794-1038	999-1319	1060-1642	1244-1985	1713-2296	1914-2569	2080-2785

\* Values are listed at 3000K, 90+ CRI with a white bevel & trim.  
Delivered lumens range based on beam spread.  
Performance may vary +/- 5%

## BEAM SPREAD

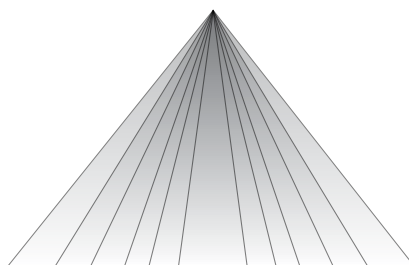

Available optics: 12° 25° 30° 40° 50° 70°

- Field replaceable TIR optics
- Easily achieve narrow spot to wide flood beam pattern
- Optional filters available upon request

## PRIME FAMILY OF PRODUCTS



Downlight



TechZone®



WoodWorks®

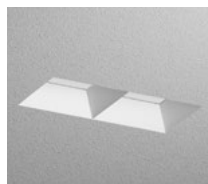

Multiple Dedicated Bevel

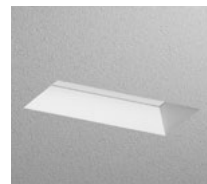

Multiple Open Bevel



Cylinder



Square Luminaire

3" LED ARCHITECTURAL SQUARE FLANGELESS DOWNLIGHT

NEW CONSTRUCTION: IC & NON IC

ORDERING INFORMATION

Series	Wattage	Dimming	Color Temperature	Optical Lens	Filter	Housing Type
RPA3	6W - 6 Watt	ID <sup>2</sup> - Standard All-Inclusive ELV, Triac, and 0–10V Dimming Driver (Intelligent Drive)	27K - 2700K	12 <sup>5,7</sup> - 12°	Blank - None	IC <sup>8</sup> - IC Air-Tight New Construction
	9W - 9 Watt	EEI <sup>3</sup> - eldoLED 1% Dim (0–10V)	30K - 3000K	25 - 25°	F - Frosted Filter	NC - Non-IC New Construction
	12W - 12 Watt	EEIS <sup>4</sup> - eldoLED 1% Dim 0-10V (120-277V), Triac (120V), Max 20W	35K - 3500K	30 - 30°	H - Honey Comb	
	15W - 15 Watt		40K - 4000K	40 - 40°	S - Solite Filter	
	20W - 20 Watt	EDIO <sup>3</sup> - eldoLED 0.1% Dim (0-10V)		50 - 50°	L - Linear Filter	
	24W - 24 Watt	EDID <sup>3</sup> - eldoLED 0.1% Dim (DALI)		70 - 70°		
	28W <sup>1</sup> - 28 Watt	EDD <sup>3</sup> - eldoLED 1% Dim (DALI2)				
	32W <sup>1</sup> - 32 Watt	LDE1 <sup>5</sup> - Lutron Hi-Lume 1% Ecosystem with Soft-on, Fade-to-Black Dimming				
		L3DA <sup>5</sup> - Hi-Lume 1% Ecosystem/3-Wire L3D Driver				
		PEQ0 - Lutron Hi-Lume Premier Ecosystem 0.1% with Soft-on, Fade-to-Black Dimming				

Collar	Module Type	Trim Style	Frame Accessories	Options
CS10 - 1.0" Depth	FMH - Downlight	LPS - Flangeless Plaster	UH - Universal Bar Hanger	ER4W <sup>9</sup> - Emergency Battery with Remote test switch (400 lm)
CS15 - 1.5" Depth		LAMS - Flangeless Millwork with Adapter	C - C-Channel Bar Hanger	ER8W <sup>10</sup> - Emergency Battery with Remote test switch (800 lm)
MTO - Made To Order		LDMS - Flangeless Millwork with Dedicated Collar		ER15W <sup>10</sup> - Emergency Battery with Remote test switch (1,500 lm)
				347V - 347V Step down transformer
				CP <sup>11</sup> - Chicago Plenum

TRIM ORDERING INFORMATION

DIE-CAST

Bevel Finish	Bevel	Finish	Notes
3" Square Flangeless Open Large	3SLO-CL	W - White	
	3SLO-CL	B - Black	
	3SLO-CL	H - Haze	
	3SLO-CL	BZ - Bronze	
	3SLO-CL	C - Clear	
	3SLO-CL	MTO - Made To Order	
3" Square Flangeless Open Small	3SLO-CS	W - White	
	3SLO-CS	B - Black	
	3SLO-CS	H - Haze	
	3SLO-CS	BZ - Bronze	
	3SLO-CS	C - Clear	
	3SLO-CS	MTO - Made To Order	
			1. Not available in IC housing.
			2. Intelligent Drive is the standard driver.
			3. Must specify logarithmic or linear eldoLED diver.
			4. Available up to 20W and programmable only in linear mode.
			5. Not offered in 6W.
			6. 12° available up to 20W.
			7. 12° spread without lens on trim.
			8. Not available in 28W and 32W.
			9. Available in IC housing only.
			10. Ceiling access is required for IC housing to replace the EM unit.
			11. Requires IC housing.

3" LED ARCHITECTURAL SQUARE FLANGELESS DOWNLIGHT  
NEW CONSTRUCTION: IC & NON IC

PERFORMANCE CHART

Optics		<sup>1</sup> 12°	25°	30°	40°	50°	70°
6W	Initial Lumens	657	955	955	955	955	955
	Delivered Lumens	586	718	755	754	726	602
	UGR		13.5	13	16.4	19.1	21
9W	Initial Lumens	890	1296	1296	1296	1296	1296
	Delivered Lumens	794	978	1034	1038	984	825
	UGR		14.6	14.3	17.7	19.6	22.3
12W	Initial Lumens	1122	1618	1618	1618	1618	1618
	Delivered Lumens	999	1225	1314	1319	1238	1051
	UGR		15.2	15.1	18.3	21.2	22.9
15W	Initial Lumens	1267	2015	2015	2015	2015	2015
	Delivered Lumens	1060	1470	1628	1642	1565	1227
	UGR		15.9	15.8	19	21.9	23.6
20W	Initial Lumens	1485	2422	2422	2422	2422	2422
	Delivered Lumens	1244	1778	1967	1985	1895	1482
	UGR		16.6	16.4	19.7	22.5	24.3
24W	Initial Lumens		2799	2799	2799	2799	2799
	Delivered Lumens		2107	2273	2296	2193	1713
	UGR		17.4	17	20.2	23.1	24.8
28W	Initial Lumens		3128	3128	3128	3128	3128
	Delivered Lumens		2343	2542	2569	2458	1914
	UGR		17.7	17.3	20.6	23.6	25.2
32W	Initial Lumens		3405	3405	3405	3405	3405
	Delivered Lumens		2544	2768	2785	2679	2080
	UGR		18	17.7	20.9	23.9	25.4

\* Values are listed at 3000K, 90+ CRI with a white bevel & trim.

Notes  
1. 12° spread without lens on trim

COLOR TEMPERATURE MULTIPLIER FOR DELIVERED LUMENS

2700K	3000K	3500K	4000K
0.95	1.00	1.04	1.07

DIFFUSED LENS



- Listed IES files are with diffused lens

OPTIONAL FIELD REMOVABLE LENS



- Not suitable for wet locations
- Increase in lumens by approximately 7%

## 3" LED ARCHITECTURAL SQUARE FLANGELESS DOWNLIGHT

NEW CONSTRUCTION: IC & NON IC

### NON-IC HOUSING DIMENSIONS 6W-20W

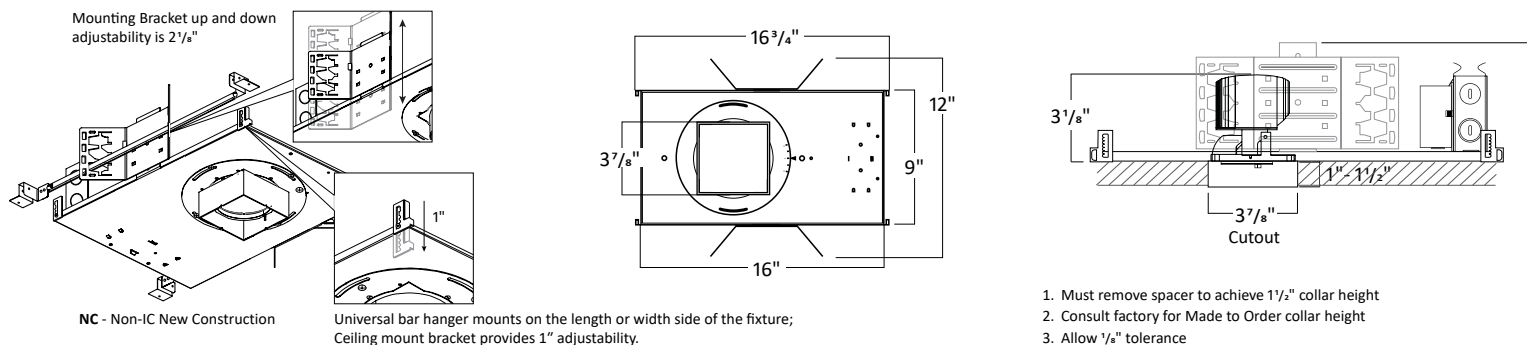

### NON-IC HOUSING DIMENSIONS 24W-32W

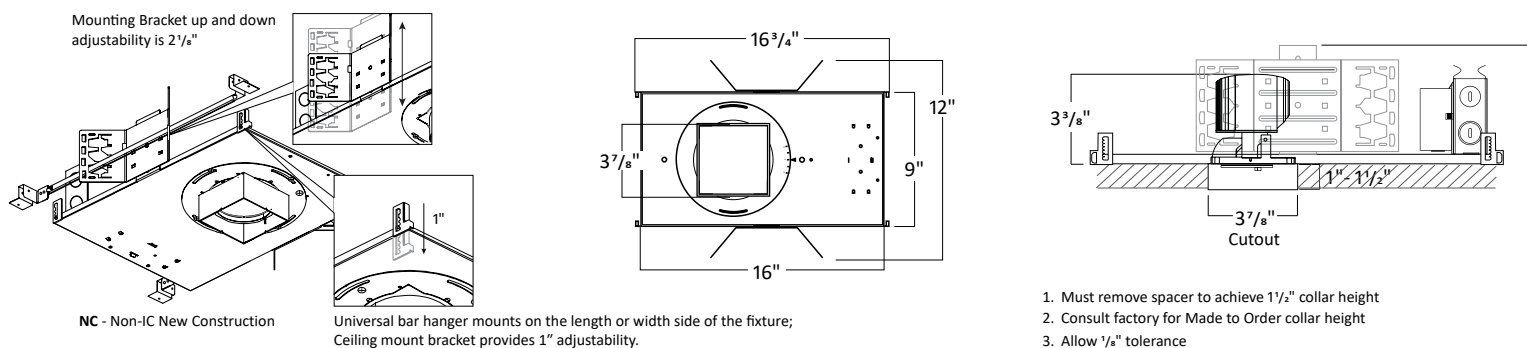

### IC HOUSING DIMENSIONS 6W-24W

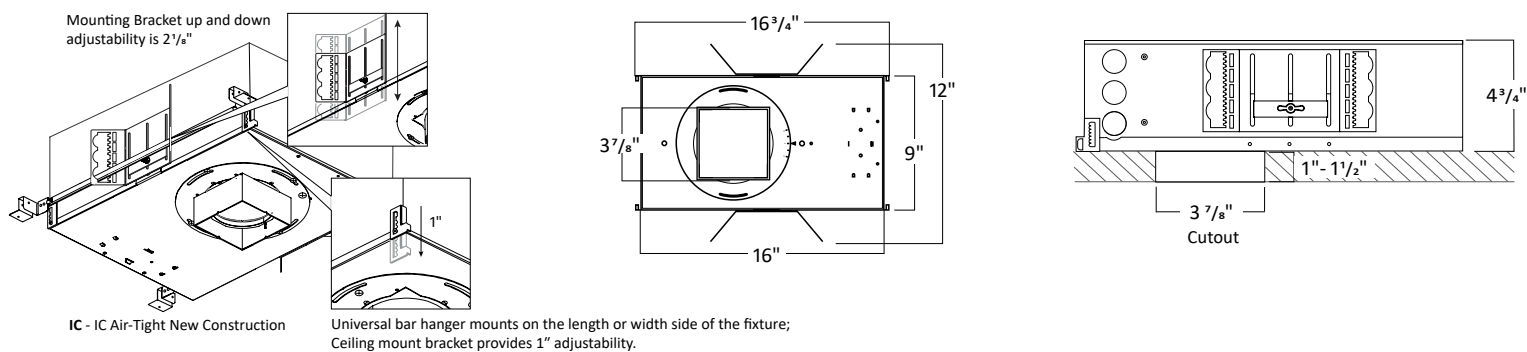

## 3" LED ARCHITECTURAL SQUARE FLANGELESS DOWNLIGHT

NEW CONSTRUCTION: IC & NON IC

### FRAME ACCESSORIES

#### UNIVERSAL BAR HANGER

##### COMPATIBLE CEILING

- Hat Channel
- T-Bar
- C-Channel
- Laminated Wood
- Quick-Span
- I-Beam
- Standard Joist

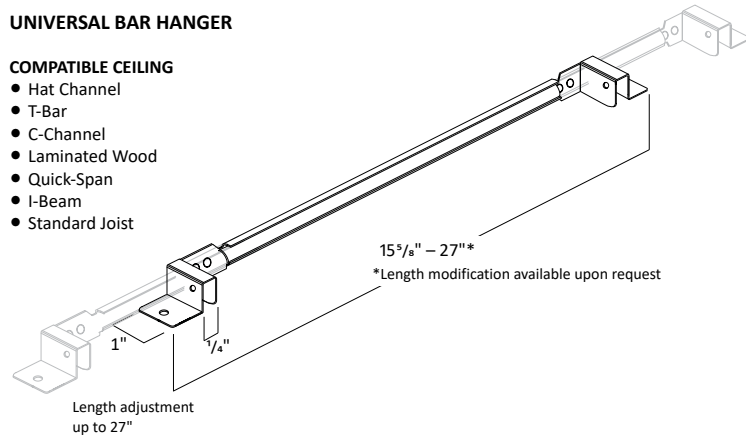

#### C-CHANNEL BAR HANGER

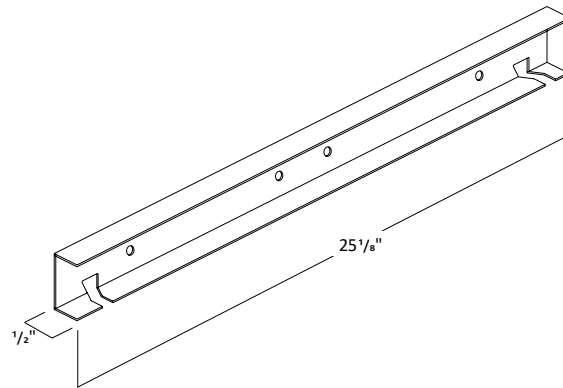

### MODULE DIMENSIONS

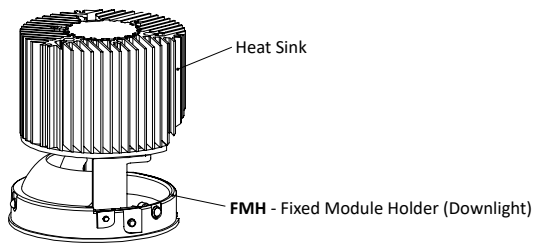

### FILTERS

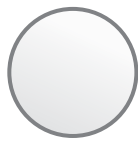

Frosted Filter

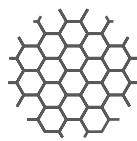

Honey Comb

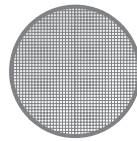

Solite Filter

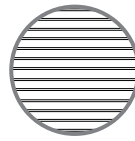

Linear Filter

## 3" LED ARCHITECTURAL SQUARE FLANGELESS DOWNLIGHT NEW CONSTRUCTION: IC & NON IC

### FLANGELESS PLASTER (LPS)

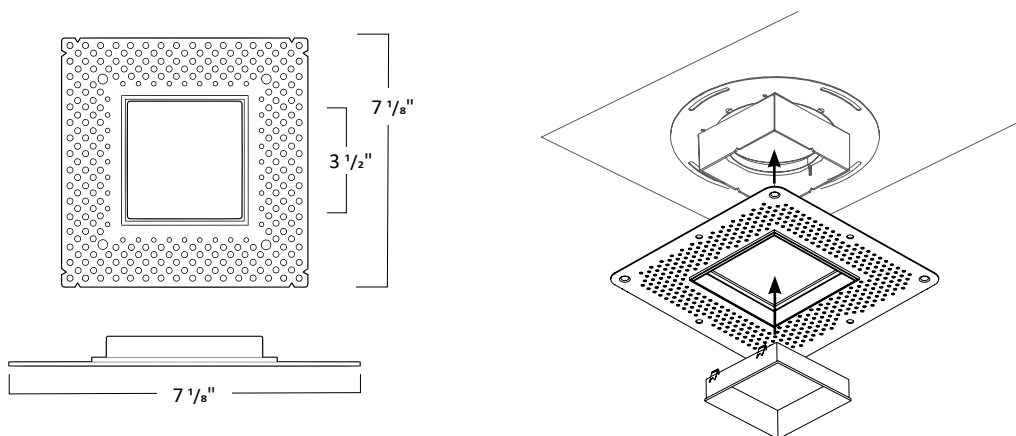

### FLANGELESS MILLWORK WITH ADAPTER (LAMS)

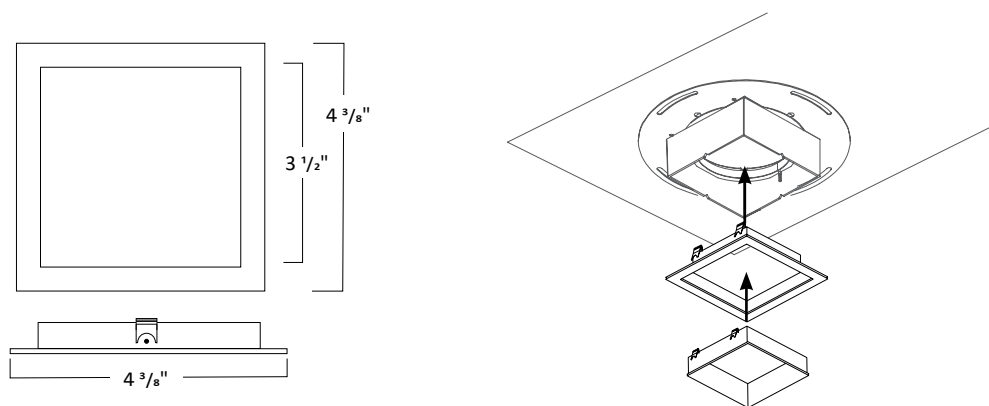

### FLANGELESS MILLWORK WITH DEDICATED COLLAR (LDMS)

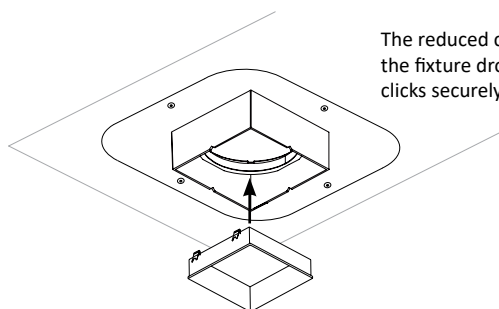
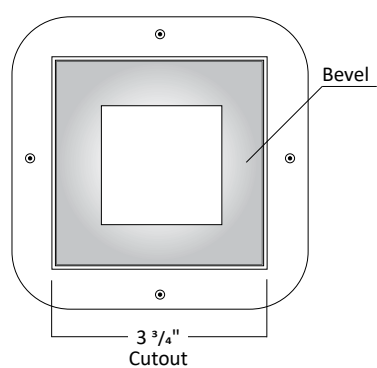

The reduced collar diameter allows for easy installation; the fixture drops into the ceiling opening and the bevel clicks securely into the collar.

TRIM DIMENSIONS

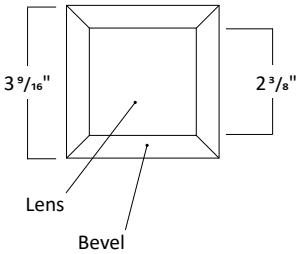
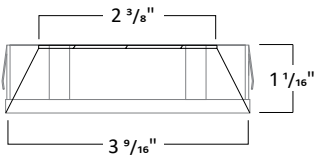
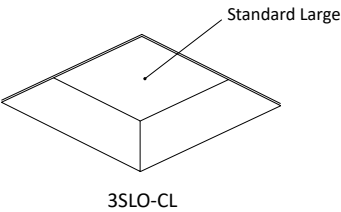
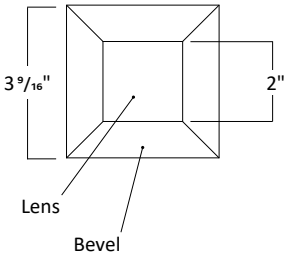
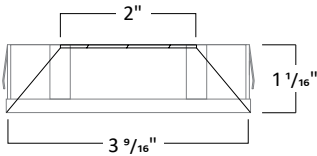
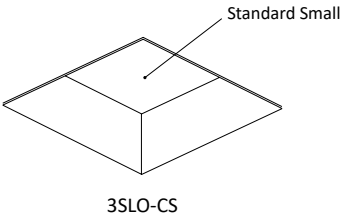

TRIM FINISH



\*Consult Factory for Made to Order Finishes

## 3" LED ARCHITECTURAL SQUARE FLANGELESS DOWNLIGHT

NEW CONSTRUCTION: IC & NON IC

### REMOTE EMERGENCY BATTERY: NON-IC NEW CONSTRUCTION HOUSING

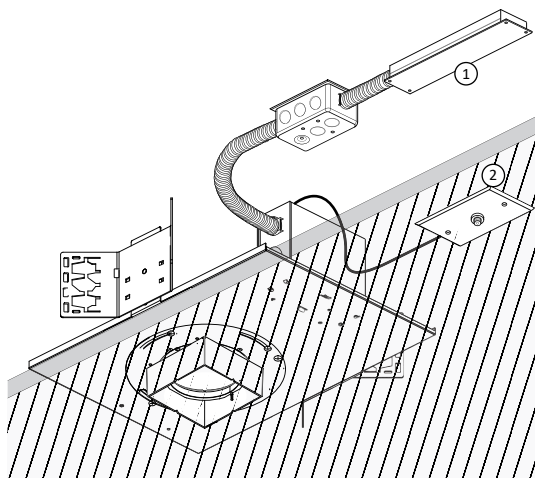

**NC** - Non-IC New Construction

**ER8W** and **ER15W** is an 8W and 15W Emergency Battery that is remote to the fixture with a remote test switch. The EM unit is accessible from below the ceiling for replacement purposes.

1. Remote Emergency Battery
2. Remote Test Switch

### REMOTE EMERGENCY BATTERY: IC NEW CONSTRUCTION HOUSING

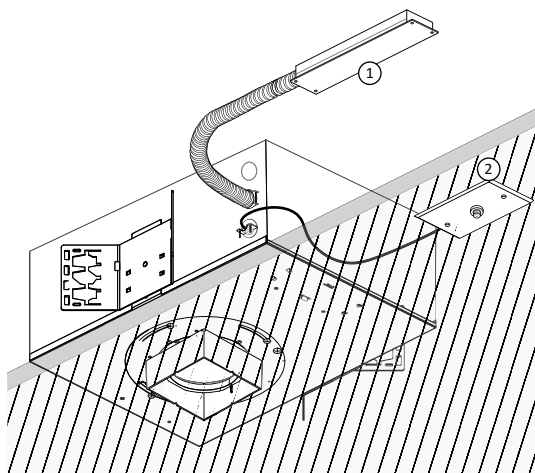

**IC** - IC Air-Tight New Construction

**ER8W** and **ER15W** is an 8W and 15W Emergency Battery that is remote to the fixture with a remote test switch. Ceiling access is required for replacement purposes

1. Remote Emergency Battery
2. Remote Test Switch

### INTEGRAL EMERGENCY BATTERY: IC NEW CONSTRUCTION HOUSING

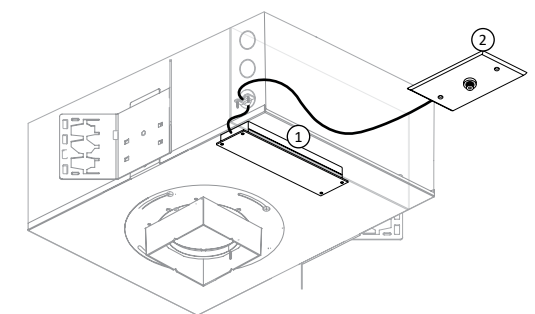

**IC** - IC Air-Tight New Construction

**ER4W** is an 4W Emergency Battery that is integral to the fixture with an remote test switch. The EM unit is accessible from below the ceiling for replacement purposes.

\*Available in IC housing only

1. Integral Emergency Battery
2. Remote Test Switch