

## 4" LED ARCHITECTURAL ROUND FLANGELESS WALL WASH

### NEW CONSTRUCTION: IC & NON IC



## GENERAL INFORMATION

### USE OF PRODUCT

The 4" Prime Wall Wash is the ideal product for architectural energy efficient lighting in commercial and residential applications for illuminating the wall. Available options include die-cast or anodized aluminum trims, various temperatures, optics, lumen outputs, and dimmable drivers.

### LED ENGINE

LED engine available in 2700K, 3000K, 3500K, or 4000K in standard 90+ CRI. 2-step MacAdam ellipse allows for color consistency between fixtures. The LED is mounted to an aluminum heat sink for maximum life output and thermal management. Light engine provides a quick disconnect with locking strain relief to housing.

### OPTICAL LENS

Field replaceable optical lenses are available in 15°, 24°, 36°, 50° and 80°. Easily achieve narrow spot to wide flood beam pattern.

### FRAME CONSTRUCTION

IC and Non-IC rated housing are constructed from a 16-gauge heavy-duty, powder-coated cold-rolled steel frame and includes a junction box with ½" knockouts. Butterfly brackets (included) accommodate universal or C-channel hangers (order separately).

### ADJUSTMENT

- Light engine locked at 20° tilt, consult factory for other tilt setting.
- Housing supports 359° locking rotation.
- Aperture collar compatible up to 1½" ceiling thickness.
- Accommodation for 2" or 3" ceiling thickness available upon request.

### DIMMING

Available in nine driver selections. (ID) Standard all-inclusive ELV (120V), Triac (120V), and 0–10V (120–277V) dimming driver called Intelligent Drive, (EEI) eldoLED 1% Dim 0-10V, (EES) eldoLED 1% Dim 0-10V (120-277V) and Triac (120V), Max 20W, (EDIO) eldoLED 0.1 Dim 0-10V, (EDID) eldoLED 0.1% Dim DALI, (EDD) eldoLED 1% Dim DALI2, (LDE1) Lutron Hi-Lume 1% Ecosystem with Soft-on, Fade-to-Black Dimming, (L3DA) Hi-Lume 1% Ecosystem/3-Wire L3D Driver, (PEQ0) Lutron Hi-Lume Premier Ecosystem 0.1% with Soft-on, Fade-to-Black Dimming.

### BEVEL

Bevel includes standard frosted acrylic diffuser. Remove standard frosted acrylic diffuser in field for 7% lumens increase. Consult factory for made-to-order finishes. Wet location for bathrooms and showers with standard lens on trim.

### EMERGENCY BATTERY

Optional Emergency Battery (EM) available in 4W (≈400 lm), 8W (≈800 lm), or 15W (≈1,500 lm) available for a minimum of 90 minutes. Please review page 8 for integral or remote EM and test switch options with solutions that allow for EM replacement from below the ceiling.

### LABELS/COMPLIANCE/WARRANTY

- CSA listed for US and Canada
- Energy Star certified product
- Dry/Damp/Wet location rated
- State of California Title 24 and JA8 compliant
- Chicago Plenum with IC Housing
- 5-year limited warranty.



## GENERAL PERFORMANCE CHART

\*Detailed performance chart may be found on page 3

	6W	9W	12W	15W	20W	24W	28W	32W
<b>Initial Lumens</b>	955	1296	1618	2015	2422	2799	3128	3405
<b>Delivered Lumens</b>	418-687	569-933	713-1170	868-1426	1056-1735	1240-2036	1425-2339	1620-2668

\* Values are listed at 3000K, 90+ CRI with a white bevel & trim.  
Delivered lumens range based on beam spread.  
Performance may vary +/- 5%

## BEAM SPREAD

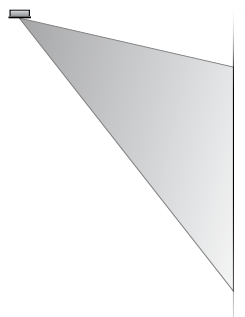

Field replaceable TIR optics

## PRIME FAMILY OF PRODUCTS



Downlight



TechZone®



WoodWorks®

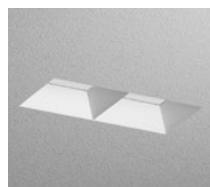

Multiple Dedicated Bevel

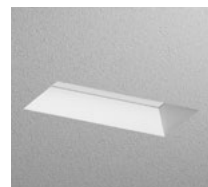

Multiple Open Bevel



Cylinder



Square Luminaire

4" LED ARCHITECTURAL ROUND FLANGELESS WALL WASH

NEW CONSTRUCTION: IC & NON IC

ORDERING INFORMATION

Series	Wattage	Dimming	Color Temperature	Optical Lens	Housing Type
RPA4	6W - 6 Watt	ID <sup>1</sup> - Standard All-Inclusive ELV, Triac, and 0–10V Dimming Driver (Intelligent Drive)	27K - 2700K	15 - 15°	IC - IC Air-Tight New Construction
	9W - 9 Watt	EEI <sup>2</sup> - eldoLED 1% Dim (0–10V)	30K - 3000K	24 - 24°	NC - Non-IC New Construction
	12W - 12 Watt	EEIS <sup>3</sup> - eldoLED 1% Dim 0-10V (120-277V), Triac (120V), Max 20W	35K - 3500K	36 - 36°	
	15W - 15 Watt	EDIO <sup>2</sup> - eldoLED 0.1% Dim (0-10V)	40K - 4000K	50 - 50°	
	20W - 20 Watt	EDID <sup>2</sup> - eldoLED 0.1% Dim (DALI)		80 - 80°	
	24W - 24 Watt	EDD <sup>2</sup> - eldoLED 1% Dim (DALI2)			
	28W - 28 Watt	LDE1 <sup>4</sup> - Lutron Hi-Lume 1% Ecosystem with Soft-on, Fade-to-Black Dimming			
	32W - 32 Watt	L3DA <sup>4</sup> - Hi-Lume 1% Ecosystem/3-Wire L3D Driver			
		PEQ0 - Lutron Hi-Lume Premier Ecosystem 0.1% with Soft-on, Fade-to-Black Dimming			

Collar	Module Type	Trim Style	Frame Accessories	Options
CR15 <sup>5</sup> - 1.5" Depth	AMHW - Wall Wash	LPR - Flangeless Plaster	UH - Universal Bar Hanger	ER4W <sup>6</sup> - Emergency Battery with Remote Switch (400 lm)
CR20 - 2.0" Depth		LAMR - Flangeless Millwork with Adapter	C - C-Channel Bar Hanger	EI4W <sup>6</sup> - Emergency Battery with Integral Switch (400 lm)
CR25 - 2.5" Depth		LDMR - Flangeless Millwork with Dedicated Collar		ER8W <sup>7</sup> - Emergency Battery with Remote Switch (800 lm)
MTO - Made To Order				EI8W <sup>7</sup> - Emergency Battery with Integral Switch (800 lm)
				ER15W <sup>7</sup> - Emergency Battery with Remote Switch (1,500 lm)
				EI15W <sup>7</sup> - Emergency Battery with Integral Switch (1,500 lm)
				347V - 347V Step down transformer
				CP <sup>8</sup> - Chicago Plenum

TRIM ORDERING INFORMATION

Bevel Finish	Bevel
4" Round Flangeless Accent	4RLAW - White bevel 4RLAH - Haze bevel 4RLAWE - Wheat bevel 4RLAS - Specular clear bevel 4RLAB - Black bevel 4RLAMTO - Made to order

- Notes
1. Intelligent Drive is the standard driver.

2. Must specify logarithmic or linear eldoLED diver.

3. Available up to 20W and programmable only in linear mode.

4. Not offered in 6W.

5. Standard Collar Height.

6. Available in IC housing only.

7. Ceiling access is required for IC housing to replace the EM unit.

8. Requires IC housing.

4" LED ARCHITECTURAL ROUND FLANGELESS WALL WASH  
NEW CONSTRUCTION: IC & NON IC

PERFORMANCE CHART

Optics		15°	24°	36°	50°	80°
6W	Initial Lumens	995	955	955	955	955
	Delivered Lumens	632	666	687	586	418
9W	Initial Lumens	1296	1296	1296	1296	1296
	Delivered Lumens	860	906	933	796	569
12W	Initial Lumens	1618	1618	1618	1618	1618
	Delivered Lumens	1077	1136	1170	997	713
15W	Initial Lumens	2015	2015	2015	2015	2015
	Delivered Lumens	1312	1383	1426	1213	868
20W	Initial Lumens	2422	2422	2422	2422	2422
	Delivered Lumens	1595	1682	1735	1476	1056
24W	Initial Lumens	2799	2799	2799	2799	2799
	Delivered Lumens	1870	1972	2036	1732	1240
28W	Initial Lumens	3128	3128	3128	3128	3128
	Delivered Lumens	2147	2266	2339	1986	1425
32W	Initial Lumens	3405	3405	3405	3405	3405
	Delivered Lumens	2437	2584	2668	2264	1620

COLOR TEMPERATURE MULTIPLIER FOR DELIVERED LUMENS

2700K	3000K	3500K	4000K
0.95	1.00	1.04	1.07

DIFFUSED LENS



• Listed IES files are with diffused lens

## 4" LED ARCHITECTURAL ROUND FLANGELESS WALL WASH

NEW CONSTRUCTION: IC & NON IC

### NON-IC HOUSING DIMENSIONS 6W-20W

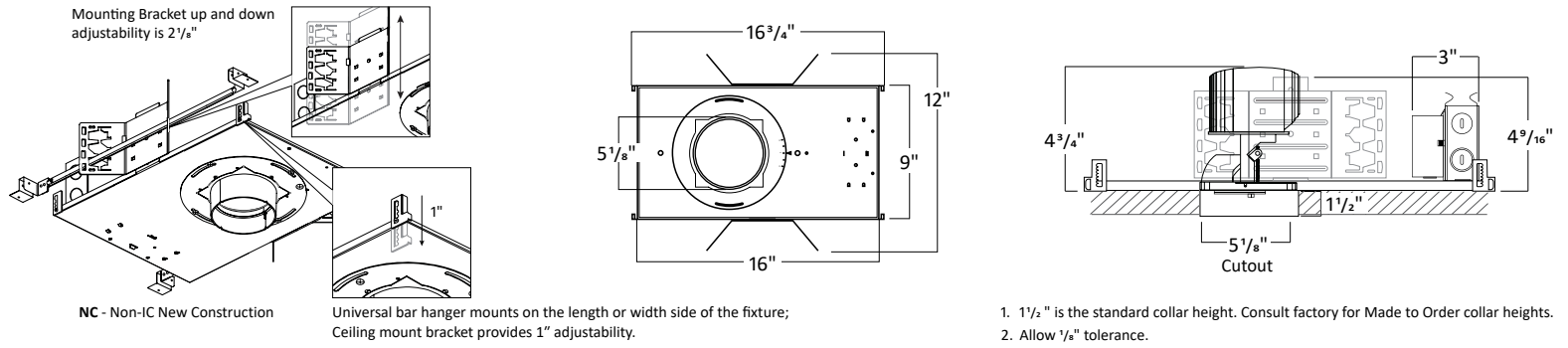

### NON-IC HOUSING DIMENSIONS 24W-32W

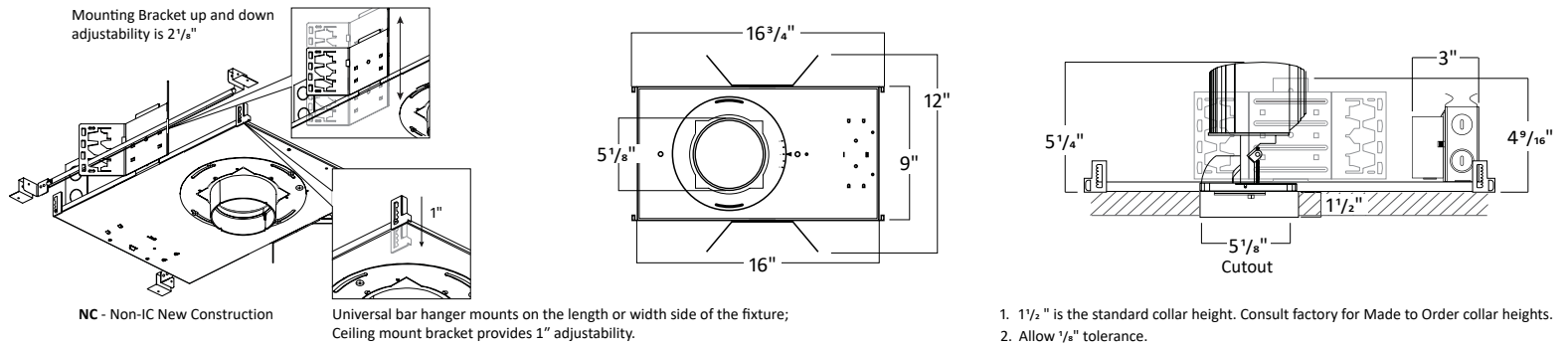

### IC HOUSING DIMENSIONS 6W-32W

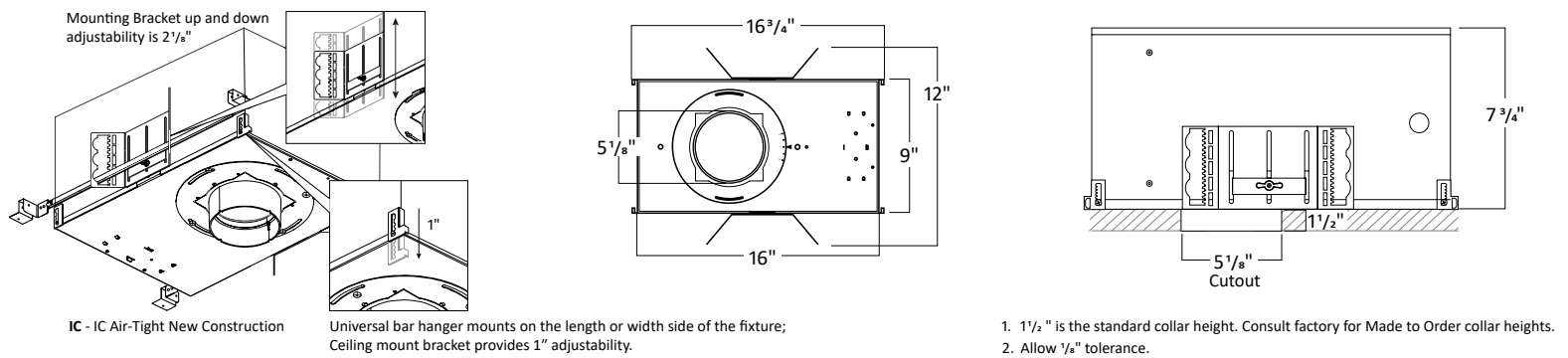

## 4" LED ARCHITECTURAL ROUND FLANGELESS WALL WASH NEW CONSTRUCTION: IC & NON IC

### FRAME ACCESSORIES

#### UNIVERSAL BAR HANGER

##### COMPATIBLE CEILING

- Hat Channel
- T-Bar
- C-Channel
- Laminated Wood
- Quick-Span
- I-Beam
- Standard Joist

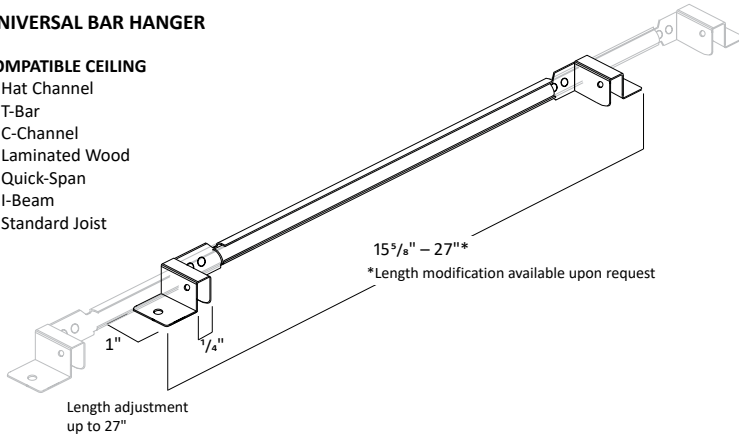

#### C-CHANNEL BAR HANGER

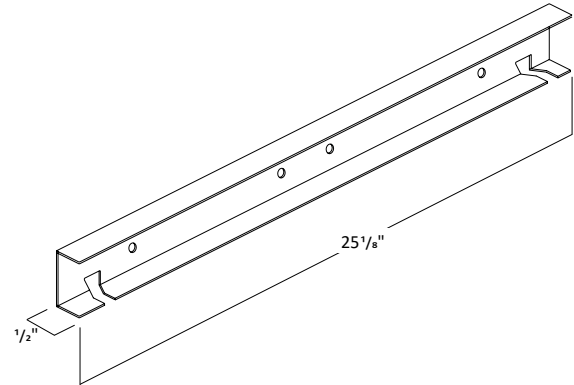

### MODULE DIMENSIONS

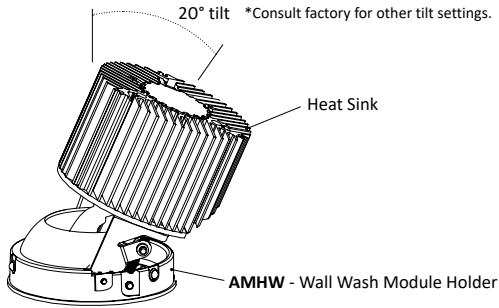

## 4" LED ARCHITECTURAL ROUND FLANGELESS WALL WASH NEW CONSTRUCTION: IC & NON IC

### FLANGELESS PLASTER (LPR)

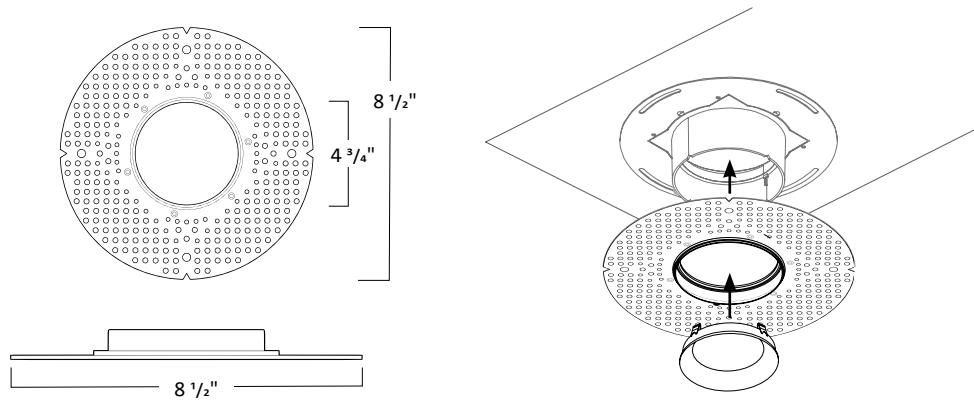

### FLANGELESS MILLWORK WITH ADAPTER (LAMR)

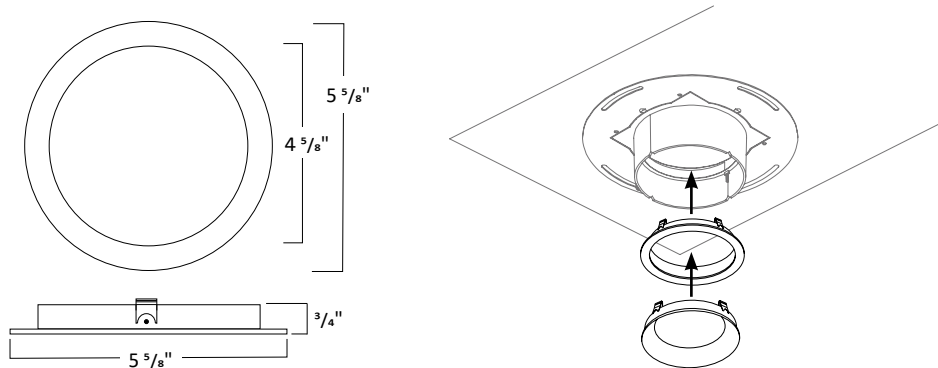

### FLANGELESS MILLWORK WITH DEDICATED COLLAR (LDMR)

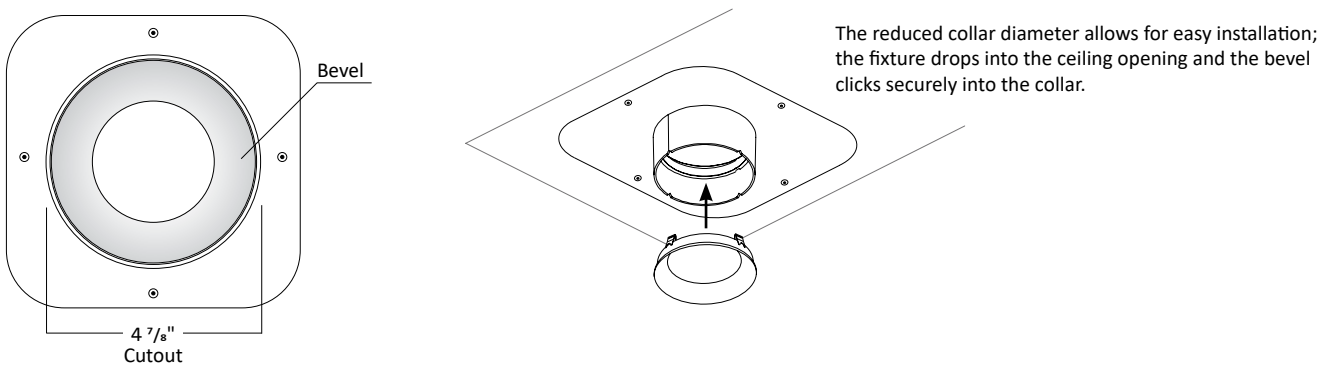

TRIM DIMENSIONS

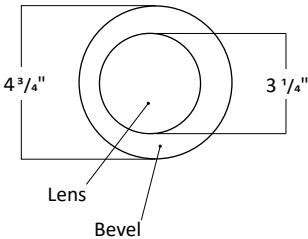
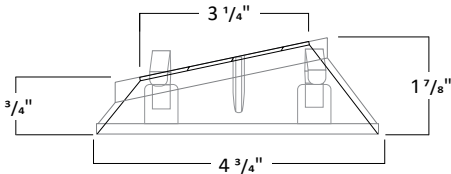
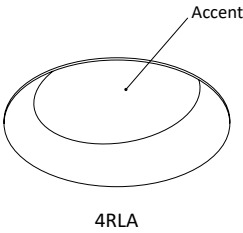

TRIM FINISH



\*Consult Factory for Made to Order Finishes

## 4" LED ARCHITECTURAL ROUND FLANGELESS WALL WASH NEW CONSTRUCTION: IC & NON IC

### REMOTE EMERGENCY BATTERY: NON-IC NEW CONSTRUCTION HOUSING

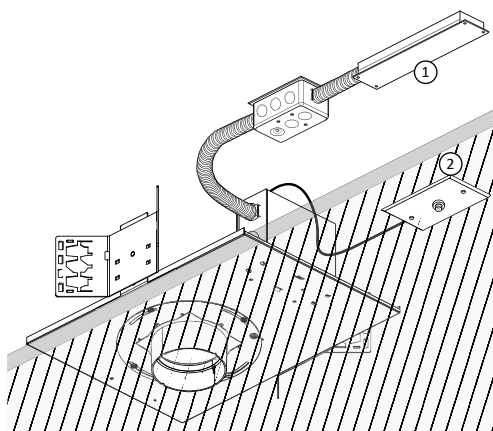

**NC - Non-IC New Construction**

**ER8W** and **ER15W** is an 8W and 15W Emergency Battery that is remote to the fixture with a remote test switch. The EM unit is accessible from below the ceiling for replacement purposes.

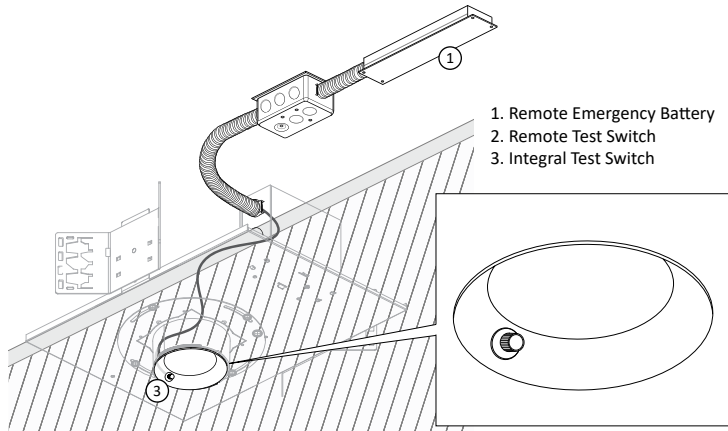

**NC - Non-IC New Construction**

**EI8W** and **EI15W** is an 8W and 15W Emergency Battery that is remote to the fixture with an integral test switch. The EM unit is accessible from below the ceiling for replacement purposes.

### REMOTE EMERGENCY BATTERY: IC NEW CONSTRUCTION HOUSING

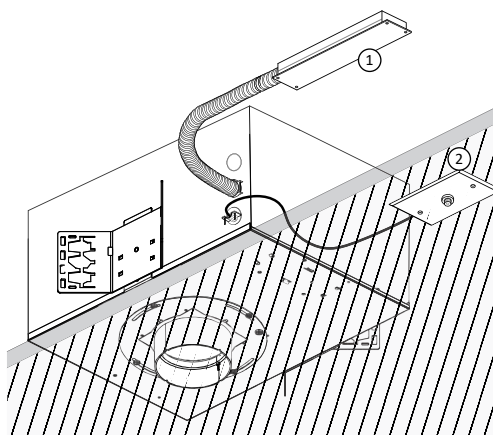

**IC - IC Air-Tight New Construction**

**ER8W** and **ER15W** is an 8W and 15W Emergency Battery that is remote to the fixture with a remote test switch. Ceiling access is required for replacement purposes.

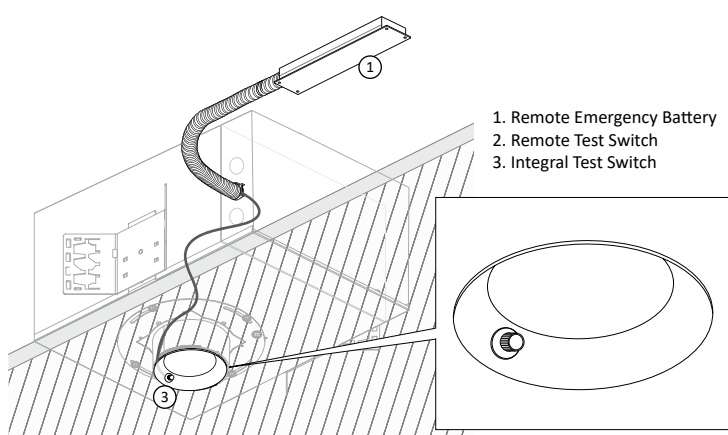

**IC - IC Air-Tight New Construction**

**EI8W** and **EI15W** is an 8W and 15W Emergency Battery that is remote to the fixture with an integral test switch. Ceiling access is required for replacement purposes.

### INTEGRAL EMERGENCY BATTERY: IC NEW CONSTRUCTION HOUSING

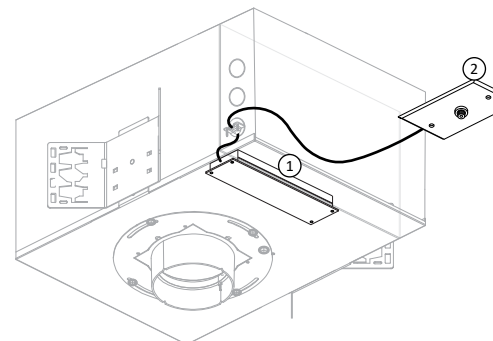

**IC - IC Air-Tight New Construction**

**ER4W** is a 4W Emergency Battery that is integral to the fixture with an remote test switch. The EM unit is accessible from below the ceiling for replacement purposes.

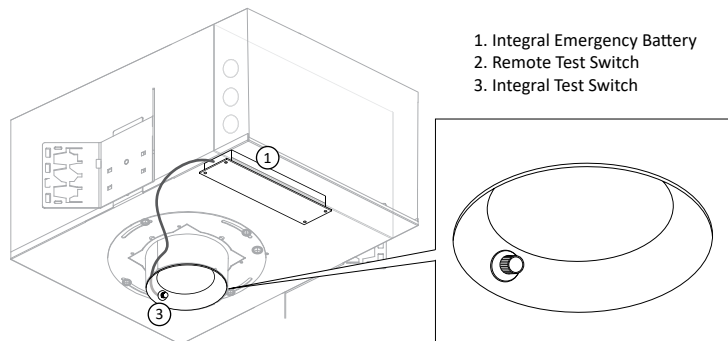

**IC - IC Air-Tight New Construction**

**EI4W** is a 4W Emergency Battery that is integral to the fixture with an integral test switch. The EM unit is accessible from below the ceiling for replacement purposes.

\*Available in IC housing only