

6" LED ARCHITECTURAL ROUND FLANGELESS DOWNLIGHT

NEW CONSTRUCTION: IC & NON IC



GENERAL INFORMATION

USE OF PRODUCT

The 6" Prime Downlight is the ideal product for architectural energy efficient lighting in commercial and residential applications. Available in die cast trims, with an assortment of optics and dimmable drivers

LED ENGINE

LED engine available in 2700K, 3000K, 3500K, or 4000K in standard 90+ CRI. 2-step MacAdam ellipse allows for color consistency between fixtures. The LED is mounted to an aluminum heat sink for maximum life output and thermal management. Light engine provides a quick disconnect with locking strain relief to housing.

OPTICAL LENS

Field replaceable optical lenses are available in 15°, 24°, 30°, 35°, 40°, 50° and 75°. Easily achieve narrow spot to wide flood beam pattern.

FRAME CONSTRUCTION

IC and Non-IC rated housing are constructed from a 16-gauge heavy-duty, powder-coated cold-rolled steel frame and includes a junction box with ½" knockouts. Butterfly brackets (included) accommodate universal or C-channel hangers (order separately).

ADJUSTMENT

- Housing supports 359° locking rotation.
- Aperture collar compatible up to 1½" ceiling thickness.
- Accommodation for 2" or 3" ceiling thickness available upon request.

DIMMING

Available in nine driver selections. (ID) Standard all-inclusive ELV (120V), Triac (120V), and 0–10V (120–277V) dimming driver called Intelligent Drive, (EEI) eldoLED 1% Dim 0-10V, (EES) eldoLED 1% Dim 0-10V (120-277V) and Triac (120V), Max 20W, (EDIO) eldoLED 0.1 Dim 0-10V, (EDID) eldoLED 0.1% Dim DALI, (EDD) eldoLED 1% Dim DALI2, (LDE1) Lutron Hi-Lume 1% Ecosystem with Soft-on, Fade-to-Black Dimming, (L3DA) Hi-Lume 1% Ecosystem/3-Wire L3D Driver, (PEQ0) Lutron Hi-Lume Premier Ecosystem 0.1% with Soft-on, Fade-to-Black Dimming.

BEVEL

Bevel includes standard frosted acrylic diffuser. Remove standard frosted acrylic diffuser in field for 7% lumens increase. Consult factory for made-to-order finishes. Wet location for bathrooms and showers with standard lens on trim.

EMERGENCY BATTERY

Optional Emergency Battery (EM) available in 4W (~400 lm), 8W (~800 lm), or 15W (~1,500 lm) available for a minimum of 90 minutes. Please review page 8 for integral or remote EM and test switch options with solutions that allow for EM replacement from below the ceiling.

LABELS/COMPLIANCE/WARRANTY

- CSA listed for US and Canada
- Energy Star certified product
- Dry/Damp/Wet location rated
- State of California Title 24 and JA8 compliant
- Chicago Plenum with IC Housing
- 5-year limited warranty



GENERAL PERFORMANCE CHART

*Detailed performance chart may be found on page 3

| | 6W | 9W | 12W | 15W | 20W | 24W | 28W | 32W | 33W | 35W | 40W | 48W | 56W |
|------------------|---------|----------|-----------|-----------|-----------|-----------|-----------|-----------|-----------|-----------|-----------|-----------|-----------|
| Initial Lumens | 955 | 1296 | 1618 | 2015 | 2422 | 2799 | 3128 | 3405 | 4090 | 4626 | 4967 | 5786 | 6472 |
| Delivered Lumens | 703-831 | 962-1138 | 1217-1436 | 1477-1740 | 1797-2124 | 2094-2496 | 2369-2870 | 2610-3209 | 2948-3430 | 3267-3787 | 3571-4158 | 4149-4885 | 4668-6472 |

* Values are listed at 3000K, 90+ CRI with a white bevel & trim.
Delivered lumens range based on beam spread.
Performance may vary +/- 5%

BEAM SPREAD

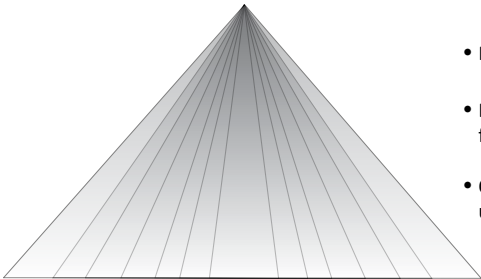

Available optics: 15° 24° 30° 35° 40° 50° 75°

- Field replaceable TIR optics
- Easily achieve narrow spot to wide flood beam pattern
- Optional filters available upon request

PRIME FAMILY OF PRODUCTS

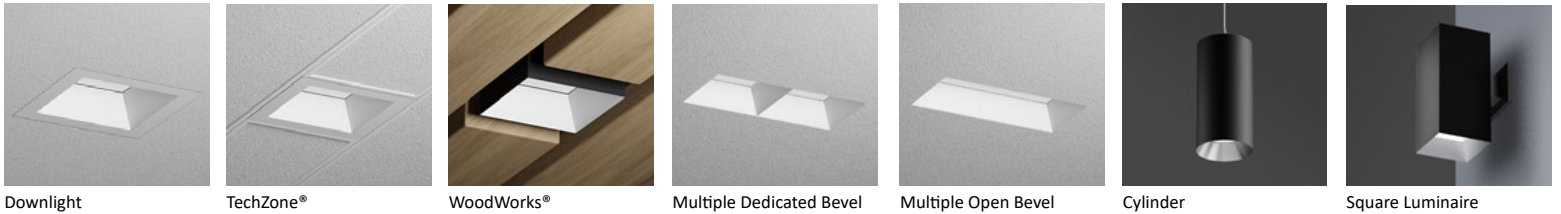

Integer Lights continually works to improve products and reserves the right to make changes which may alter the performance, appearance or specification of products.

6" LED ARCHITECTURAL ROUND FLANGELESS DOWNLIGHT

NEW CONSTRUCTION: IC & NON IC

ORDERING INFORMATION

| Series | Wattage | Dimming | Color Temperature | Optical Lens | Filter | Housing Type |
|--------|----------------------------|---|-------------------|-------------------------|--------------------|---|
| RPA6 | 6W - 6 Watt | ID ² - Standard All-Inclusive ELV, Triac, and 0–10V Dimming Driver (Intelligent Drive) | 27K - 2700K | 15 ^{6,7} - 15° | Blank - None | IC ⁸ - IC Air-Tight New Construction |
| | 9W - 9 Watt | | 30K - 3000K | 24 ⁷ - 24° | F - Frosted Filter | NC - Non-IC New Construction |
| | 12W - 12 Watt | EEI ³ - eldoLED 1% Dim (0–10V) | 35K - 3500K | 30- 30° | H - Honey Comb | |
| | 15W - 15 Watt | EEIS ⁴ - eldoLED 1% Dim 0-10V (120-277V), | 40K - 4000K | 35 - 35° | S - Solite Filter | |
| | 20W - 20 Watt | Triac (120V), Max 20W | | 40 - 40° | L - Linear Filter | |
| | 24W - 24 Watt | EDIO ³ - eldoLED 0.1% Dim (0-10V) | | 50 - 50° | | |
| | 28W - 28 Watt | EDID ³ - eldoLED 0.1% Dim (DALI) | | 75 - 75° | | |
| | 32W - 32 Watt | EDD ³ - eldoLED 1% Dim (DALI2) | | | | |
| | 33W ¹ - 33 Watt | LDE1 ⁵ - Lutron Hi-Lume 1% Ecosystem with Soft-on, Fade-to-Black Dimming | | | | |
| | 35W ¹ - 35 Watt | | | | | |
| | 40W ¹ - 40 Watt | L3DA ⁵ - Hi-Lume 1% Ecosystem/3-Wire L3D Driver | | | | |
| | 48W ¹ - 48 Watt | PEQ0 - Lutron Hi-Lume Premier Ecosystem 0.1% with Soft-on, Fade-to-Black Dimming | | | | |
| | 56W ¹ - 56 Watt | | | | | |

| Collar | Module Type | Trim Style | Frame Accessories | Options |
|--------------------------------|-----------------|--|---------------------------|---|
| CR15 ⁹ - 1.5" Depth | FMH - Downlight | LPR - Flangeless Plaster | UH - Universal Bar Hanger | ER4W ¹⁰ - Emergency Battery with Remote Switch (400 lm) |
| CR20 - 2.0" Depth | | LAMR - Flangeless Millwork with Adapter | C - C-Channel Bar Hanger | EI4W ¹⁰ - Emergency Battery with Integral Switch (400 lm) |
| CR25 - 2.5" Depth | | | | ER8W ¹¹ - Emergency Battery with Remote Switch (800 lm) |
| MTO - Made To Order | | LDMR - Flangeless Millwork with Dedicated Collar | | EI8W ¹¹ - Emergency Battery with Integral Switch (800 lm) |
| | | | | ER15W ¹¹ - Emergency Battery with Remote Switch (1,500 lm) |
| | | | | EI15W ¹¹ - Emergency Battery with Integral Switch (1,500 lm) |
| | | | | 347V - 347V Step down transformer |
| | | | | CP ¹² - Chicago Plenum |

TRIM ORDERING INFORMATION

| Bevel Finish | Bevel | Notes |
|--------------------------|------------------------------|---|
| 6" Round Flangeless Open | 6RLOW - White bevel | 1. Not available in IC housing. |
| | 6RLOH - Haze bevel | 2. Intelligent Drive is the standard driver. |
| | 6RLOWE - Wheat bevel | 3. Must specify logarithmic or linear eldoLED diver. |
| | 6RLOS - Specular clear bevel | 4. Available up to 20W and programmable only in linear mode. |
| | 6RLOB - Black bevel | 5. Not offered in 6W. |
| | 6RLOMTO - Made to order | 6. Available in 6W-32W only. |
| | | 7. 15° and 24° spread without lens on trim. |
| | | 8. Not available in 33W-56W. |
| | | 9. Standard collar height. |
| | | 10. Available in IC housing only. |
| | | 11. Ceiling access is required for IC housing to replace the EM unit. |
| | | 12. Requires IC housing. |

6" LED ARCHITECTURAL ROUND FLANGELESS DOWNLIGHT

NEW CONSTRUCTION: IC & NON IC

PERFORMANCE CHART

| Optics | | ^{1,2} 15° | ² 24° | 30° | 35° | 40° | 50° | 75° |
|--------|------------------|--------------------|------------------|------|------|------|------|------|
| 6W | Initial Lumens | 955 | 955 | 955 | 955 | 955 | 955 | 955 |
| | Delivered Lumens | 813 | 831 | 782 | 806 | 811 | 764 | 703 |
| | UGR | | | 10.1 | 9.8 | 11.6 | 15.6 | 19 |
| 9W | Initial Lumens | 1296 | 1296 | 1296 | 1296 | 1296 | 1296 | 1296 |
| | Delivered Lumens | 1109 | 1138 | 1066 | 1107 | 1108 | 1033 | 962 |
| | UGR | | | 11.6 | 11.2 | 12.9 | 17 | 20.4 |
| 12W | Initial Lumens | 1618 | 1618 | 1618 | 1618 | 1618 | 1618 | 1618 |
| | Delivered Lumens | 1400 | 1436 | 1338 | 1404 | 1390 | 1288 | 1217 |
| | UGR | | | 12.2 | 11.8 | 13.6 | 17.5 | 21 |
| 15W | Initial Lumens | 2015 | 2015 | 2015 | 2015 | 2015 | 2015 | 2015 |
| | Delivered Lumens | 1712 | 1740 | 1631 | 1682 | 1669 | 1537 | 1477 |
| | UGR | | | 12.9 | 12.5 | 14.3 | 18.3 | 21.7 |
| 20W | Initial Lumens | 2422 | 2422 | 2422 | 2422 | 2422 | 2422 | 2422 |
| | Delivered Lumens | 2080 | 2124 | 1962 | 2044 | 2032 | 1868 | 1797 |
| | UGR | | | 13.6 | 13.2 | 15 | 19 | 22.4 |
| 24W | Initial Lumens | 2799 | 2799 | 2799 | 2799 | 2799 | 2799 | 2799 |
| | Delivered Lumens | 2421 | 2496 | 2285 | 2378 | 2369 | 2175 | 2094 |
| | UGR | | | 14.1 | 13.7 | 15.5 | 19.5 | 23 |
| 28W | Initial Lumens | 3128 | 3128 | 3128 | 3128 | 3128 | 3128 | 3128 |
| | Delivered Lumens | 2763 | 2870 | 2586 | 2682 | 2677 | 2454 | 2369 |
| | UGR | | | 14.6 | 14.1 | 16 | 19.9 | 23.4 |
| 32W | Initial Lumens | 3405 | 3405 | 3405 | 3405 | 3405 | 3405 | 3405 |
| | Delivered Lumens | 3042 | 3209 | 2841 | 2955 | 2950 | 2702 | 2610 |
| | UGR | | | 14.9 | 14.5 | 16.3 | 20.2 | 23.7 |
| 33W | Initial Lumens | | 4090 | | 4090 | 4090 | 4090 | 4090 |
| | Delivered Lumens | | 3413 | | 3312 | 3430 | 3352 | 2948 |
| | UGR | | | | 17.7 | 17.5 | 19 | 24.4 |
| 35W | Initial Lumens | | 4626 | | 4626 | 4626 | 4626 | 4626 |
| | Delivered Lumens | | 3787 | | 3604 | 3787 | 3722 | 3267 |
| | UGR | | | | 18 | 17.8 | 19.4 | 24.8 |
| 40W | Initial Lumens | | 4967 | | 4967 | 4967 | 4967 | 4967 |
| | Delivered Lumens | | 4158 | | 3938 | 4127 | 4075 | 3571 |
| | UGR | | | | 18.3 | 18.2 | 19.7 | 25.1 |
| 48W | Initial Lumens | | 5765 | | 5765 | 5765 | 5765 | 5765 |
| | Delivered Lumens | | 4885 | | 4577 | 4787 | 4740 | 4149 |
| | UGR | | | | 18.8 | 18.7 | 20.2 | 25.6 |
| 56W | Initial Lumens | | 6472 | | 6472 | 6472 | 6472 | 6472 |
| | Delivered Lumens | | 5619 | | 5146 | 5378 | 5337 | 4668 |
| | UGR | | | | 19.2 | 19.1 | 20.6 | 26 |

* Values are listed at 3000K, 90+ CRI with a white bevel & trim.

Notes

1. Available in 6W-32W only
2. 15° and 24° spread without lens on trim

COLOR TEMPERATURE MULTIPLIER FOR DELIVERED LUMENS

| 2700K | 3000K | 3500K | 4000K |
|-------|-------|-------|-------|
| 0.95 | 1.00 | 1.04 | 1.07 |

DIFFUSED LENS



- Listed IES files are with diffused lens

OPTIONAL FIELD REMOVABLE LENS



- Not suitable for wet locations
- Increase in lumens by approximately 7%

6" LED ARCHITECTURAL ROUND FLANGELESS DOWNLIGHT NEW CONSTRUCTION: IC & NON IC

NON-IC HOUSING DIMENSIONS 6W-20W

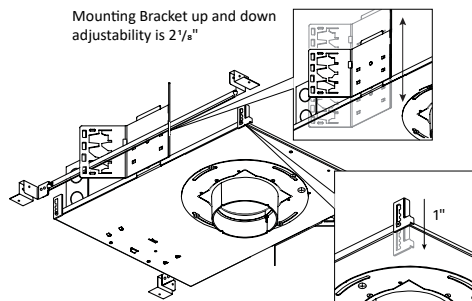

Universal bar hanger mounts on the length or width side of the fixture; Ceiling mount bracket provides 1" adjustability.

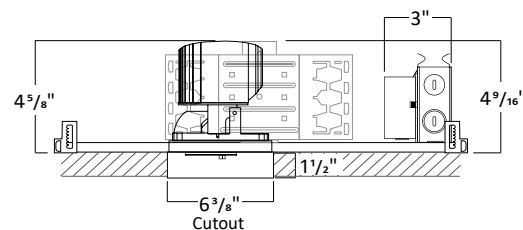
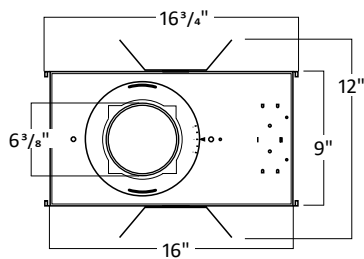

1. $1\frac{1}{2}"$ is the standard collar height. Consult factory for Made to Order collar heights.
2. Allow $\frac{1}{8}"$ tolerance.

NON-IC HOUSING DIMENSIONS 24W-56W

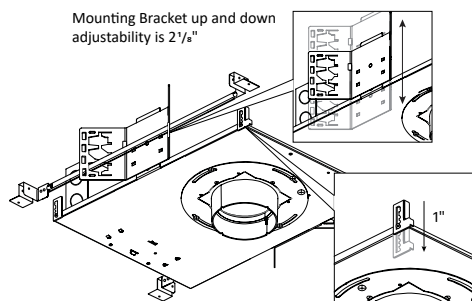

Universal bar hanger mounts on the length or width side of the fixture; Ceiling mount bracket provides 1" adjustability.

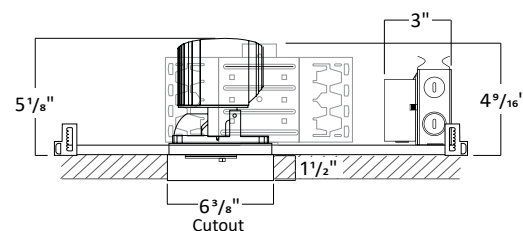
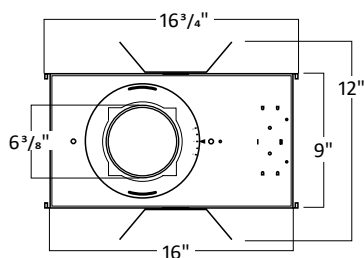

1. $1\frac{1}{2}"$ is the standard collar height. Consult factory for Made to Order collar heights.
2. Allow $\frac{1}{8}"$ tolerance.

IC HOUSING DIMENSIONS 6W-32W

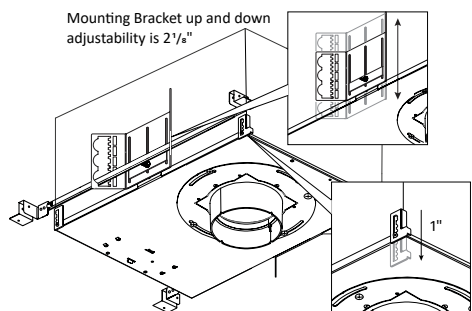

Universal bar hanger mounts on the length or width side of the fixture; Ceiling mount bracket provides 1" adjustability.

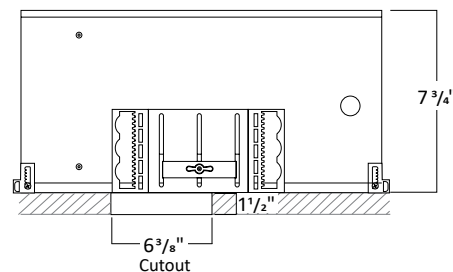
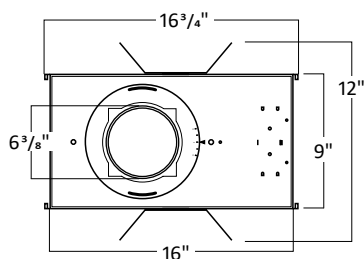

1. $1\frac{1}{2}"$ is the standard collar height. Consult factory for Made to Order collar heights.
2. Allow $\frac{1}{8}"$ tolerance.

6" LED ARCHITECTURAL ROUND FLANGELESS DOWNLIGHT NEW CONSTRUCTION: IC & NON IC

FRAME ACCESSORIES

UNIVERSAL BAR HANGER

COMPATIBLE CEILING

- Hat Channel
- T-Bar
- C-Channel
- Laminated Wood
- Quick-Span
- I-Beam
- Standard Joist

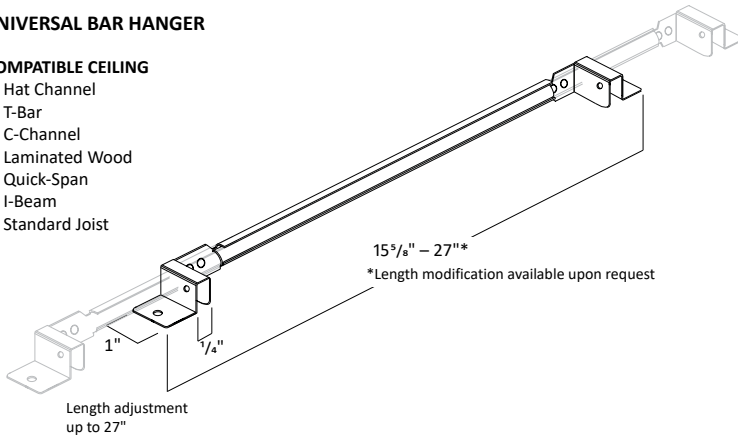

C-CHANNEL BAR HANGER

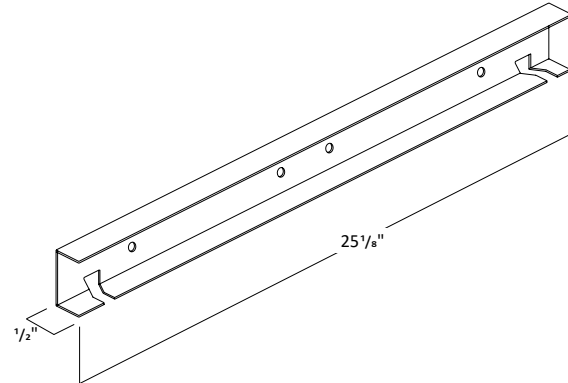

MODULE DIMENSIONS

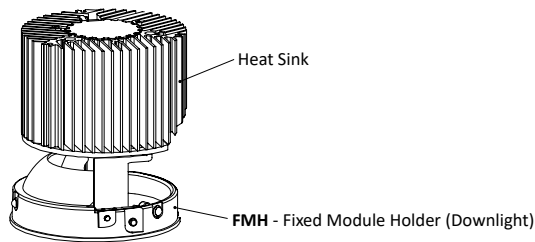

FILTERS

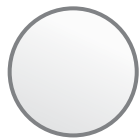

Frosted Filter

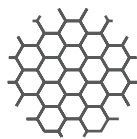

Honey Comb

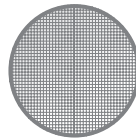

Solite Filter



Linear Filter

6" LED ARCHITECTURAL ROUND FLANGELESS DOWNLIGHT NEW CONSTRUCTION: IC & NON IC

FLANGELESS PLASTER (LPR)

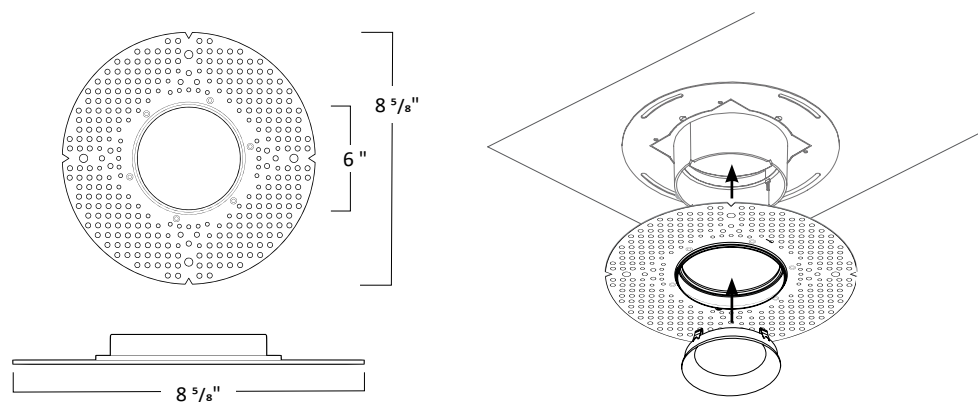

FLANGELESS MILLWORK WITH ADAPTER (LAMR)

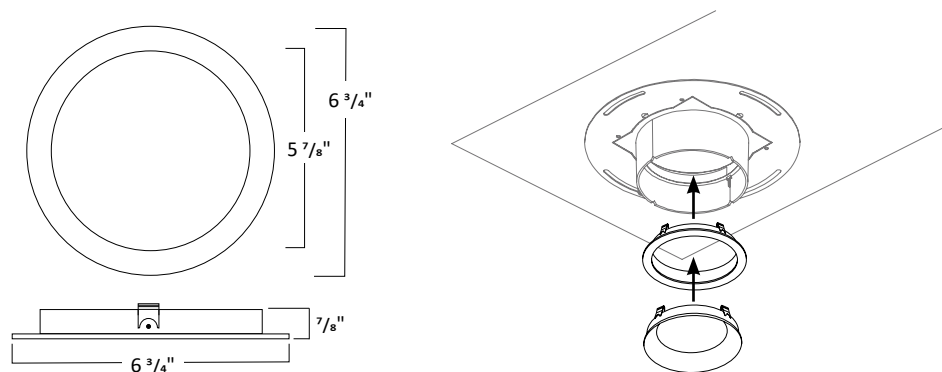

FLANGELESS MILLWORK WITH DEDICATED COLLAR (LDMR)

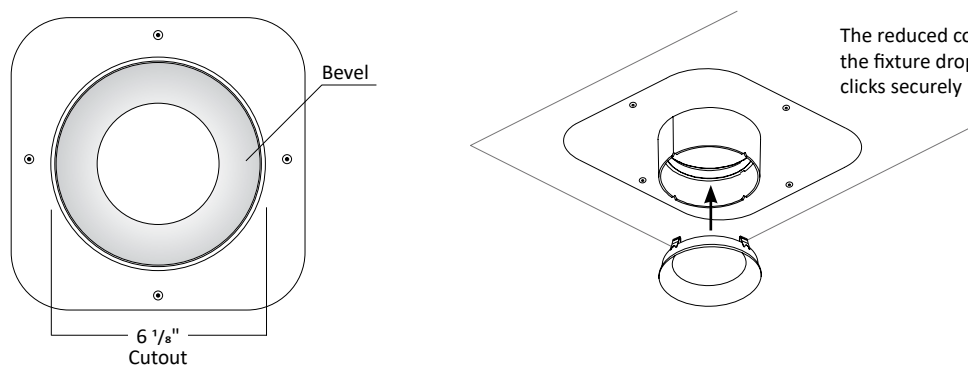

The reduced collar diameter allows for easy installation; the fixture drops into the ceiling opening and the bevel clicks securely into the collar.

TRIM DIMENSIONS

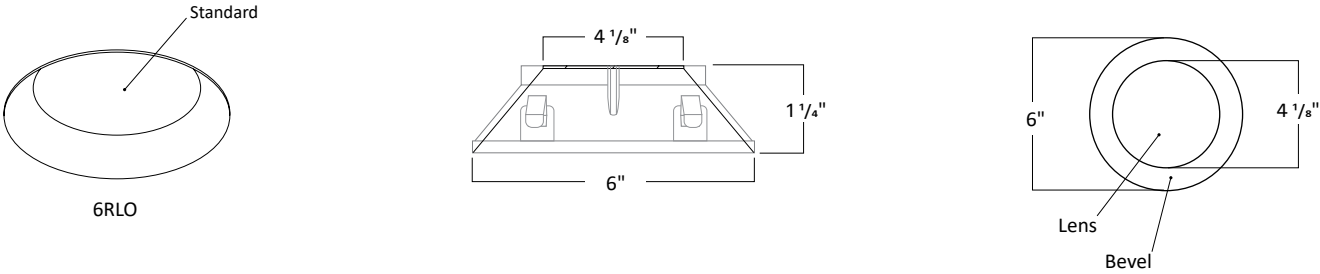

TRIM FINISH



*Consult Factory for Made to Order Finishes

6" LED ARCHITECTURAL ROUND FLANGELESS DOWNLIGHT NEW CONSTRUCTION: IC & NON IC

REMOTE EMERGENCY BATTERY: NON-IC NEW CONSTRUCTION HOUSING

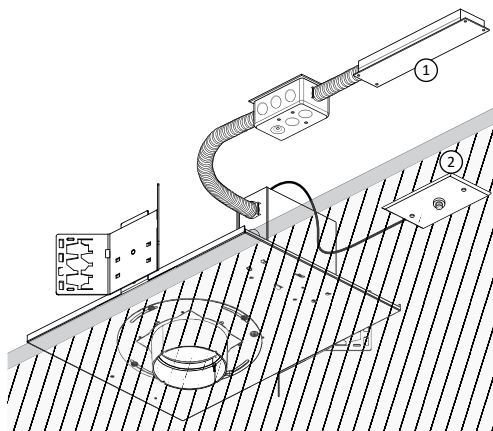

NC - Non-IC New Construction

ER8W and **ER15W** is an 8W and 15W Emergency Battery that is remote to the fixture with a remote test switch. The EM unit is accessible from below the ceiling for replacement purposes.

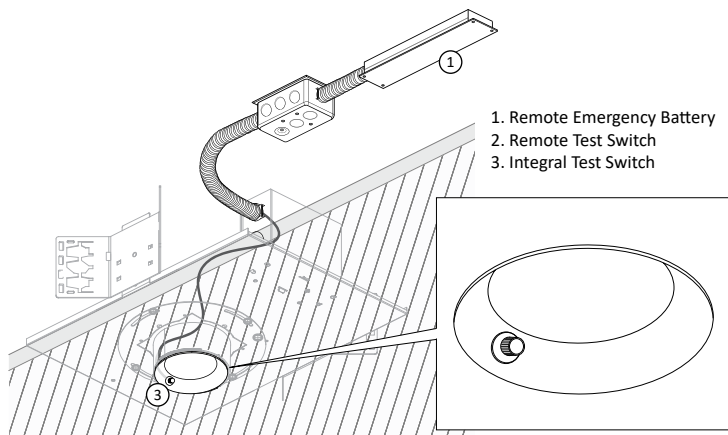

NC - Non-IC New Construction

EI8W and **EI15W** is an 8W and 15W Emergency Battery that is remote to the fixture with an integral test switch. The EM unit is accessible from below the ceiling for replacement purposes.

REMOTE EMERGENCY BATTERY: IC NEW CONSTRUCTION HOUSING

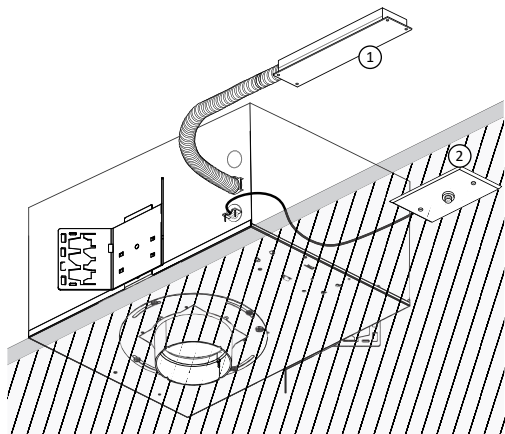

IC - IC Air-Tight New Construction

ER8W and **ER15W** is an 8W and 15W Emergency Battery that is remote to the fixture with a remote test switch. Ceiling access is required for replacement purposes.

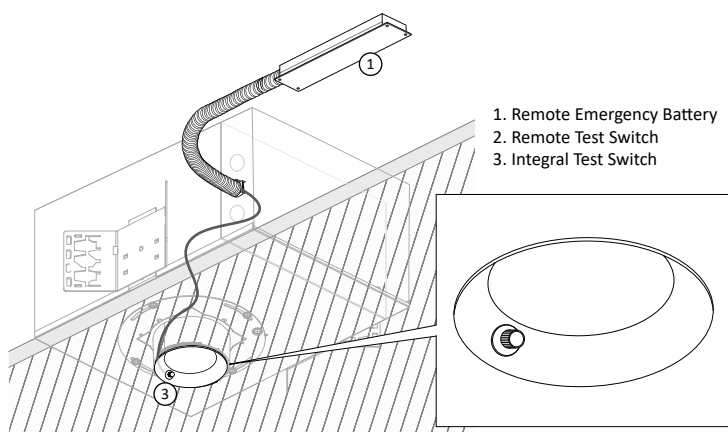

IC - IC Air-Tight New Construction

EI8W and **EI15W** is an 8W and 15W Emergency Battery that is remote to the fixture with an integral test switch. Ceiling access is required for replacement purposes.

INTEGRAL EMERGENCY BATTERY: IC NEW CONSTRUCTION HOUSING

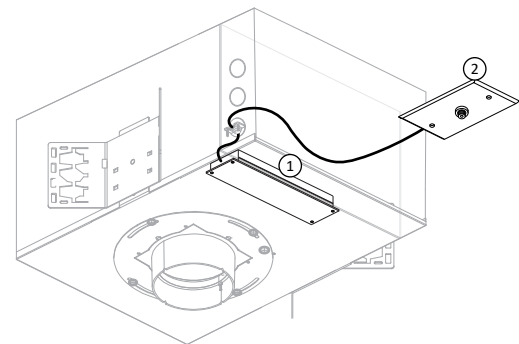

IC - IC Air-Tight New Construction

ER4W is a 4W Emergency Battery that is integral to the fixture with an remote test switch. The EM unit is accessible from below the ceiling for replacement purposes.

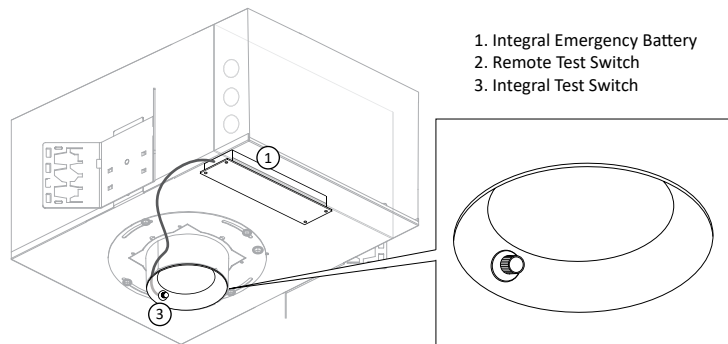

IC - IC Air-Tight New Construction

EI4W is a 4W Emergency Battery that is integral to the fixture with an integral test switch. The EM unit is accessible from below the ceiling for replacement purposes.

*Available in IC housing only